

+NOTICE!!

These documents have been scanned!

Do not place un-scanned documents beneath this notice!

Do not remove this notice from this file!

GPO Jacket No. 560-102
Print Order 61540
Rise Business Services, LLC
Job=AZ15 8/2/2019



Box Number= AZ15210



Claim Begin-End: AMC203191-AMC203191

1 Initial Receipt



AZ15210-4

AMC196365-AMC210385

UNITED STATES
DEPARTMENT OF THE INTERIOR
BUREAU OF LAND MANAGEMENT

No. 480394

RECEIPT AND ACCOUNTING ADVICE

Subject: MINING CLAIMS (L)

MC/AZ aug 16 83 1 3 1 500

Applicant: ARVIN STOTT
P.O. BOX 839
BLACK CANYON CITY, AZ 85324

Remitter:

on computer 8/17/83
\$ CASH

Assignor:

LEASE MANAGEMENT DATA (Check appropriate box)

NEW

UPDATE

PAYMENT

SERIAL NUMBER	*	ASG	TYPE	ST	CTY	FUND SYMBOL	ACRES/UNIT	RATE	
AMC XX 003191			HONEYBEE						
			BLADER CLAIM						
AMOUNT	ANV. DATE	EXP. DATE	BILL CYC.	S/C	DISTRICT	NEXT BILL	MISC. DATA	U of M	ACTUAL UNITS
ASSIGNMENT DATA	NEW SERIAL NUMBER	*	ASG	ACRES/UNITS	RATE	AMOUNT	EFF. DATE		
ASSIGNED AREA									
RETAINED AREA									

APPLY REMITTANCE

Remarks:

ACTION	FUND SYMBOL	CTY	AMOUNT
FILING FEE			
RENTAL			
REFUND			
UNEARNED			
OTHER			
TOTAL			
AMOUNT DUE			

Transfer to

Amount Transferred:

Transfer from

Date Transferred:

Commit to Unit Plan

Operating Rights?

Discovery

Operator:

Partial Assignment

Of Interest?

Bond Filed?

By:

Date:

UNITED STATES
DEPARTMENT OF THE INTERIOR
BUREAU OF LAND MANAGEMENT

No. 480394

RECEIPT AND ACCOUNTING ADVICE

Subject: MINING CLAIMS (1) MC/AZ aug 16 83 1 3 1 500
 Applicant: ARVIN STOTT
 P.O. BOX 939
 BLACK CANYON CITY, AZ 85324
 Remitter: On computer 8/17/83
 * CASH

LEASE MANAGEMENT DATA (Check appropriate box) NEW UPDATE PAYMENT

SERIAL NUMBER	*	ASG	TYPE	ST	CTY	FUND SYMBOL	ACRES/UNIT	RATE	
203191			HONEYBEE		BLACER CLAIM				
AMOUNT	ANV. DATE	EXP. DATE	BILL CYC.	S/C	DISTRICT	NEXT BILL	MISC. DATA	U of M	ACTUAL UNITS
ASSIGNMENT DATA	NEW SERIAL NUMBER	*	ASG	ACRES/UNITS	RATE	AMOUNT	EFF. DATE		
ASSIGNED AREA									
RETAINED AREA									

APPLY REMITTANCE			
ACTION	FUND SYMBOL	CTY	AMOUNT
FILING FEE			
RENTAL			
REFUND			
UNEARNED			
OTHER			
TOTAL			
AMOUNT DUE			

Remarks:

Transfer to Amount Transferred:
 Transfer from Date Transferred:
 Commit to Unit Plan Operating Rights?
 Discovery Operator:
 Partial Assignment

Of Interest? Bond Filed? By: Date:

NOTICE!!

These documents have been scanned!

Do not place un-scanned documents beneath this notice!

Do not remove this notice from this file!

GPO Jacket No. 560-102
Print Order 61540
Rise Business Services, LLC
Job=AZ15 8/2/2019



Box Number= AZ15210



Claim Begin-End: AMC203191-AMC203191

2 Correspondence



AZ15210-4

AMC196365-AMC210385

**NO
DOCUMENTS
FOUND**

NO DOCUMENTS FOUND
NO DOCUMENTS FOUND

NOTICE!!

These documents have been scanned!

Do not place un-scanned documents beneath this notice!

Do not remove this notice from this file!

GPO Jacket No. 560-102
Print Order 61540
Rise Business Services, LLC
Job=AZ15 8/2/2019



Box Number= AZ15210



Claim Begin-End: AMC203191-AMC203191

3 Transfers



AZ15210-4

AMC196365-AMC210385

Amc 203191

When recorded, mail to:

Name: ROBERT JORDAN
Address: 6262 E. BROWN RD #42
MESA AZ 85205
City/State/Zip Code: _____

RECORDED YAVAPAI COUNTY ARIZONA

INSTRUMENT # 9243045
OFFICIAL RECORDS OF
YAVAPAI COUNTY
PATSY C. JENNEY
REQUEST OF:
ROBERT JORDAN
DATE: 10/06/92 TIME: 09:15
FEE: 5.00 SC: 4.00 PT: 1.00
BOOK 2541 PAGE 191 PAGES: 001

5
1
1
1
1
1
1
1
1
10

INDEXED & MICROFILMED

Space above this line for Recorder's use

QUITCLAIM DEED

KNOW ALL MEN BY THESE PRESENTS:

That I (~~we~~), Arvin V. Stott
the undersigned, for the consideration of Ten (10) Dollars, and other valuable considerations, do hereby release, remise, and forever quitclaim unto ROBERT JORDAN

all right, title and interest in that certain Property situated in Yavapai County,
State of Arizona, and described as follows: One twenty Acre mining claim - "Placer" - Name of claim is Honeybee.

Amc # 203191 situate in the Black Canyon mining District.
The Location of which is recorded in the Office of the County Recorder in Book 1560 Page 142. Claim is in Sec. 32 R. 2-E T. 9 1/2

IN WITNESS WHEREOF, I (we) have hereunto set my (our) hand(s) and seal this 23 day of Sept. 19 92.

NO TRANSFER FEE NECESSARY
EXEMPT UNDER ARS-42-1614 A-6

Arvin V. Stott
Releasor

SEAL

State of Arizona
County of Maricopa) ss.

On this 23rd day of September, 19 92, before me, the undersigned Notary Public, personally appeared Arvin V. Stott

2802 W. Foothill Dr. #3
Phoenix Az. 85027

ACKNOWLEDGMENT

PHOENIX ARIZONA

2012 AUG 18 P 2 51

RECEIVED
DLM AZ STATE OFFICE

known to me to be the individual(s) who executed the foregoing instrument and acknowledged the same to be his (her) (their) free act and deed.

My Commission Expires: _____
Notary Public

ENTERED INTO COMPUTER
8/22/2012



Mr. Robert Jordan

8-15-12

For Quit Claim Deed

Honey Bee # 20391

owner

Name Change to

Robert Jordan

RECEIVED
BLM AZ STATE OFFICE

2012 AUG 16 A 11:01

PHOENIX, ARIZONA

Robert Jordan

THANK YOU!





Robert Jordan
6546 E Adobe Rd.
Mesa, AZ 85205-6005

PHOENIX AZ 852

15 AUG 2012 PM 4 L



RECEIVED
BLM AZ STATE OFFICE
2012 AUG 16 A 10:59
PHOENIX, ARIZONA
2012 AUG 16 A 11:01
PHOENIX, ARIZONA

*Bureau of Land Management
Study, Recreation & Planning
One N. Central ave
Phoenix, Az 85004-2203*

Attn: Suzy Cruz



Robert Jordan
6546 E. Adobe Rd.
Mesa, AZ 85205-6005

PHOENIX AZ 852

07 AUG 2012 PM 9 L



Bureau of Land Management
Arizona State Office
1 No. Central Ave, Suite 800
Phoenix Az 85004

PHOENIX ARIZONA

2012 AUG - 8 P 2:51

RECEIVED
BLM AZ STATE OFFICE

800

Attn: Suzy Cruz

85004442700

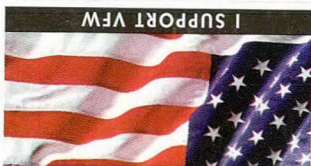



Mr. Robert Jordan
8-15-12

For Out Claim Book

Honey Bee # 20391
owner
Name Change to
Robert Jordan

RECEIVED
BLM AZ STATE OFFICE

2012 AUG 16 A 11:01

PHOENIX, ARIZONA

Robert Jordan

THANK YOU!

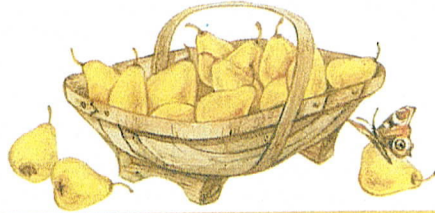

P120-1590



Robert Jordan
6546 E Adobe Rd.
Mesa, AZ 85205-6005

PHOENIX AZ 852

15 AUG 2012 PM 4 L

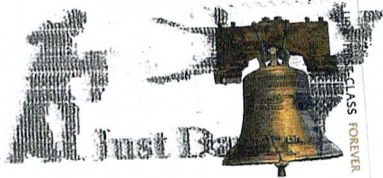

RECEIVED
BLM AZ STATE OFFICE
2012 AUG 16 A 10:59
RECEIVED
BLM AZ STATE OFFICE
2012 AUG 16 A 11:01
PHOENIX, ARIZONA
PHOENIX, ARIZONA

Bureau of Land Management
Recreation Planning
One N. Central Ave
Phoenix, AZ 85004-2203

Attn: Suzy Cruz



PHOENIX AZ 850

07 AUG 2012 PM 9 L

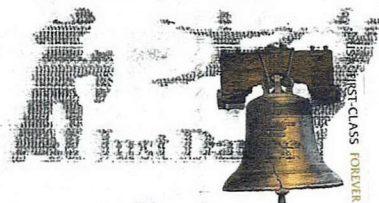

Bureau of Land Management
Arizona State Office
1 No. Central Ave, Suite 800
Phoenix Az 85004

PHOENIX ARIZONA

2012 AUG - 8 P 2: 51

RECEIVED
BLM AZ STATE OFFICE

Attn: Suzy Cruz

85004442700



United States Department of the Interior
Bureau of Land Management
 LANDS/RECREATION & PLANNING
 ONE N CENTRAL AVE
 PHOENIX, AZ 85004 -2203
 Phone: 602-417-9200

Receipt

No: 2633181

Transaction #: 2713713	
Date of Transaction: 08/17/2012	
CUSTOMER:	
ROBERT JORDAN 6546 E ADOBE RD MESA, AZ 85205-6005 US	

LINE #	QTY	DESCRIPTION	REMARKS	UNIT PRICE	TOTAL
1	1.00	LOCATABLE MINERALS / MINING CLAIMS-NOT NEW-UNADJUD, ONE AUTH NO. ONLY / MINING CLAIM MONEY RECEIVED CASES: AMC203191/\$10.00	TRF (1)	- n/a -	10.00
TOTAL:					\$10.00

PAYMENT INFORMATION			
1	AMOUNT:	10.00	POSTMARKED: N/A
	TYPE:	CHECK	RECEIVED: 08/08/2012
	CHECK NO:	6465	
	NAME:	JORDAN, ROBERT 6546 E ADOBE RD MESA AZ 85205-6005 US	

REMARKS

This receipt was generated by the automated BLM Collections and Billing System and is a paper representation of a portion of the official electronic record contained therein.

NOTICE!!

These documents have been scanned!

Do not place un-scanned documents beneath this notice!

Do not remove this notice from this file!

GPO Jacket No. 560-102
Print Order 61540
Rise Business Services, LLC
Job=AZ15 8/2/2019



Box Number= AZ15210



Claim Begin-End: AMC203191-AMC203191

4 Annual Filings



AZ15210-4

AMC196365-AMC210385

203191

UNITED STATES
DEPARTMENT OF THE INTERIOR
BUREAU OF LAND MANAGEMENT

CREDIT CARD PAYMENT
For Mining Claim Maintenance Fee

THIS IS A CHANGE OF ADDRESS

TELEPHONE SUBMISSION - ACCURACY OF THE BELOW INFORMATION IS THE RESPONSIBILITY OF THE CLAIMANT/OWNER

NAME ROBERT JORDAN
ADDRESS 6546 E ADobe RD
CITY MESA STATE AZ ZIP 85205-6005
PHONE # 480 - 985-5550

SEND RECEIPT TO Above address
 Other (Include Name and Mailing Address):

AMC NUMBER 203191 CLAIM/SITE NAME HONEYBEE

1 # of Claim/Site
x 165.00 Each
\$ 165.00 Total Charged ERG (INITIALS)
RECEIPT # 4532225

DATE STAMP

RECEIVED
STATE OFFICE
2019 AUG 14 A 10: 54
PHOENIX, ARIZONA

**** FOR OFFICIAL USE ONLY ****

DATE ENTERED INITIALS _____ VERIFIED _____

AUG 15 2019
BY: [Signature]

United States Department of the Interior
Bureau of Land Management
 DIV OF LANDS, MINRLS & ENERGY
 ONE N CENTRAL AVE
 PHOENIX, AZ 85004 -4427
 Phone: 602-417-9200

Receipt

No: 4532225

Transaction #: 4653092	
Date of Transaction: 08/14/2019	
CUSTOMER:	
ROBERT JORDAN 6546 E ADOBE RD MESA, AZ 85205-6005 US	

LINE #	QTY	DESCRIPTION	REMARKS	UNIT PRICE	TOTAL
1	1.00	LOCATABLE MINERALS / MINING CLAIMS- NOT NEW-UNADJUD, ONE AUTH NO. ONLY / MINING CLAIM MONEY RECEIVED CASES: AMC203191/\$165.00	2020 MAINT (1)	- n/a -	165.00
TOTAL:					\$165.00

PAYMENT INFORMATION					
NOTE: Items will appear on credit card statement as "Bureau of Land Mgmt CO".					
1	AMOUNT:	165.00	POSTMARKED:	N/A	
	TYPE:	CREDIT CARD	RECEIVED:	08/14/2019	
	NAME:	JORDAN, ROBERT 6546 E ADOBE RD MESA AZ 85205-6005 US			
	CARD NO:	XXXXXXXXXXXX6384	AUTH CODE:	08273C	
	NAME ON CARD:	ROBERT W JORDAN			
	SIGNATURE:	OVER THE PHONE			

REMARKS

This receipt was generated by the automated BLM Collections and Billing System and is a paper representation of a portion of the official electronic record contained therein.

UNITED STATES
DEPARTMENT OF THE INTERIOR
BUREAU OF LAND MANAGEMENT

203191

CREDIT CARD PAYMENT
For Mining Claim Maintenance Fee

TELEPHONE SUBMISSION - ACCURACY OF THE BELOW INFORMATION IS THE RESPONSIBILITY OF THE CLAIMANT/OWNER

NAME ROBERT W. JORDAN
ADDRESS 6546 E ADOBE ROAD
CITY MESA STATE AZ ZIP 85205
PHONE # 480 - 985-5550

SEND RECEIPT TO Above address
 Other (Include Name and Mailing Address):

AMC NUMBER

203191

CLAIM/SITE NAME

HONEYBEE

1 # of Claim/Site
x 155.00 Each
\$ 155.00 Total Charged _____ (INITIALS)

RECEIPT # 4226572

DATE STAMP

ENTERED
AUG 06 2018
BY: Ryan

PHOENIX, ARIZONA

2018 AUG - 3 A 10:33

RECEIVED
BLM STATE OFFICE

**** FOR OFFICIAL USE ONLY ****

DATE _____

INITIALS _____

VERIFIED _____

United States Department of the Interior
Bureau of Land Management
 DIV OF LANDS, MINRLS & ENERGY
 ONE N CENTRAL AVE
 PHOENIX, AZ 85004 -4427
 Phone: 602-417-9200

Receipt

No: 4226572

Transaction #: 4341824	
Date of Transaction: 08/03/2018	
CUSTOMER:	
ROBERT JORDAN 6546 E ADOBE RD MESA, AZ 85205-6005 US	

LINE #	QTY	DESCRIPTION	REMARKS	UNIT PRICE	TOTAL
1	1.00	LOCATABLE MINERALS / MINING CLAIMS- NOT NEW-UNADJUD, ONE AUTH NO. ONLY / MINING CLAIM MONEY RECEIVED CASES: AMC203191/\$155.00	2019 MAINT (1)	- n/a -	155.00
TOTAL:					\$155.00

PAYMENT INFORMATION			
NOTE: Items will appear on credit card statement as "Bureau of Land Mgmt CO".			
1	AMOUNT:	155.00	POSTMARKED: N/A
	TYPE:	CREDIT CARD	RECEIVED: 08/03/2018
	NAME:	JORDAN, ROBERT 6546 E ADOBE RD MESA AZ 85205-6005 US	
	CARD NO:	XXXXXXXXXXXX2558	AUTH CODE: 08045C
	NAME ON CARD:	ROBERT W JORDAN	
	SIGNATURE:		

REMARKS

This receipt was generated by the automated BLM Collections and Billing System and is a paper representation of a portion of the official electronic record contained therein.

203191

UNITED STATES
DEPARTMENT OF THE INTERIOR
BUREAU OF LAND MANAGEMENT

CREDIT CARD PAYMENT
For Mining Claim Maintenance Fee

THIS IS A CHANGE OF ADDRESS

TELEPHONE SUBMISSION - ACCURACY OF THE BELOW INFORMATION IS THE RESPONSIBILITY OF THE CLAIMANT/OWNER

NAME Robert W. Jordan
ADDRESS 6546 E. Adobe Rd
CITY Mesa STATE AZ ZIP 85205
PHONE # 480 - 905 - 5550

SEND RECEIPT TO Above address
 Other (Include Name and Mailing Address):

AMC NUMBER
203191

CLAIM/SITE NAME

1 # of Claim/Site
x 155.00 Each
\$ 155 Total Charged WJC (INITIALS)

RECEIPT # 3920312

DATE STAMP

RECEIVED
BLM AZ STATE OFFICE
2017 AUG - 3 P 1:48
PHOENIX, ARIZONA

ENTERED
AUG 04 2017
BY: Ram

**** FOR OFFICIAL USE ONLY ****
DATE _____ INITIALS _____ VERIFIED _____

**DEPARTMENT OF THE INTERIOR
BUREAU OF LAND MANAGEMENT
MINING CLAIMS
(MASS) Serial Register Page**

Run Date/Time: 08/03/17 02:48 PM

Page 1 of 2

01 10-21-1976;090STAT0090;43USC1744

Total Acres

Serial Number

Case Type 384201: PLACER CLAIM

19.980

AMC203191

Claim Name: HONEYBEE

Lead File Number

Case Disposition: ACTIVE

AMC203191

Required Maintenance Fee: \$155.00

Name & Address

Int Rel

JORDAN ROBERT
6262 E BROWN RD UNIT 42 MESA, AZ 85205-4846

CLAIMANT

County / State

District

YAVAPAI County, AZ

PHOENIX DO

Mer Twp Rng Sec

Subdivision

14 0092N 0020E 032

SE

Act Date	Code	Action Text	Action Remarks	Receipt Number
08/15/1983	403	LOCATION DATE		
08/16/1983	395	RECORDATION NOTICE RECD		
08/03/2016	782	MAINTENANCE FEE PAYMENT	2017;\$155	3620694
08/04/2015	782	MAINTENANCE FEE PAYMENT	2016;\$155	3359017
08/01/2014	782	MAINTENANCE FEE PAYMENT	2015;\$155	3091003
08/02/2013	682	MAINTENANCE FEE/\$140	2014;\$140	2845724
08/01/2012	682	MAINTENANCE FEE/\$140	2013;\$140	2620418
08/01/2011	682	MAINTENANCE FEE/\$140	2012	2394625
08/19/2010	682	MAINTENANCE FEE/\$140	2011	2195569
07/21/2009	682	MAINTENANCE FEE/\$140	2010	1962198
08/06/2008	582	MAINTENANCE FEE/\$125	2009	1755121
08/10/2007	582	MAINTENANCE FEE/\$125	2008	1540923
08/02/2006	582	MAINTENANCE FEE/\$125	2007	1326180
08/04/2005	582	MAINTENANCE FEE/\$125	2006	1122199
08/09/2004	582	MAINTENANCE FEE/\$125	2005	923828
08/04/2003	482	MAINTENANCE FEE/\$100	2004	722815
08/12/2002	482	MAINTENANCE FEE/\$100	2003	537786
08/02/2001	482	MAINTENANCE FEE/\$100	2002	348944
08/08/2000	482	MAINTENANCE FEE/\$100	2001	164829
08/16/1999	482	MAINTENANCE FEE/\$100	2000	
08/17/1998	482	MAINTENANCE FEE/\$100	1999	
08/18/1997	482	MAINTENANCE FEE/\$100	1998	
08/13/1996	482	MAINTENANCE FEE/\$100	1997	
08/08/1995	482	MAINTENANCE FEE/\$100	1996	
08/24/1994	482	MAINTENANCE FEE/\$100	1995	
08/26/1993	482	MAINTENANCE FEE/\$100	1994	
08/26/1993	482	MAINTENANCE FEE/\$100	1993;RECEIPT 2044702	
09/22/1992	480	EVID OF ASSMT FILED	1992	

DEPARTMENT OF THE INTERIOR
BUREAU OF LAND MANAGEMENT
MINING CLAIMS
(MASS) Serial Register Page

Run Date/Time: 08/03/17 02:48 PM

Page 2 of 2

08/08/2012	396	TRF OF INTEREST FILED	STOTT ARVIN	2633181
08/16/1999	113	ADDITIONAL INFO RECEIVED	RECEIPT 2296567	
08/17/1998	113	ADDITIONAL INFO RECEIVED	RECEIPT 2389364	
08/18/1997	113	ADDITIONAL INFO RECEIVED	RECEIPT 2315357	
08/13/1996	113	ADDITIONAL INFO RECEIVED	RECEIPT 2228542	
08/08/1995	113	ADDITIONAL INFO RECEIVED	RECEIPT 2147417	
08/24/1994	113	ADDITIONAL INFO RECEIVED	RECEIPT 2024534	
07/15/1988	669	LAND STATUS CHECKED		
08/16/1983	501	ACCT ADV IN LEAD FILE	AMC203191	
08/15/1983	404	COUNTY RECORDATION	0;1560;141	

Line Nr **Remarks**

United States Department of the Interior
Bureau of Land Management
 DIV OF LANDS, MINRLS & ENERGY
 ONE N CENTRAL AVE
 PHOENIX, AZ 85004 -4427
 Phone: 602-417-9200

Receipt

No: 3920312

Transaction #: 4029808	
Date of Transaction: 08/03/2017	
CUSTOMER:	
ROBERT JORDAN 6546 E ADOBE RD MESA, AZ 85205-6005 US	

LINE #	QTY	DESCRIPTION	REMARKS	UNIT PRICE	TOTAL
1	1.00	LOCATABLE MINERALS / MINING CLAIMS- NOT NEW-UNADJUD, ONE AUTH NO. ONLY / MINING CLAIM MONEY RECEIVED CASES: AMC203191/\$155.00	MAINT 2018/1	- n/a -	155.00
TOTAL:					\$155.00

PAYMENT INFORMATION			
NOTE: Items will appear on credit card statement as "Bureau of Land Mgmt CO".			
1	AMOUNT:	155.00	POSTMARKED: N/A
	TYPE:	CREDIT CARD	RECEIVED: 08/03/2017
	NAME:	JORDAN, ROBERT 6546 E ADOBE RD MESA AZ 85205-6005 US	
	CARD NO:	XXXXXXXXXXXX2558	AUTH CODE: 06796C
	NAME ON CARD:	ROBERT W JORDAN	
	EXPIRES:	12/2019	
	SIGNATURE:		

REMARKS

This receipt was generated by the automated BLM Collections and Billing System and is a paper representation of a portion of the official electronic record contained therein.

UNITED STATES
DEPARTMENT OF THE INTERIOR
BUREAU OF LAND MANAGEMENT

203191

CREDIT CARD PAYMENT
For Mining Claim Maintenance Fee

THIS IS A CHANGE OF ADDRESS

TELEPHONE SUBMISSION - ACCURACY OF THE BELOW INFORMATION IS THE RESPONSIBILITY OF THE CLAIMANT/OWNER

NAME ROBERT W. JORDAN
ADDRESS 6546 E. ADOBE ROAD
CITY MESA STATE AZ ZIP 85205
PHONE # 480 - 9855550

SEND RECEIPT TO Above address
 Other (Include Name and Mailing Address):

AMC NUMBER
203191

CLAIM/SITE NAME
HONEY BEE

1 # of Claim/Site
x 155.00 Each
\$ 155.00 Total Charged CM (INITIALS)

RECEIPT # 3620694

DATE STAMP

RECEIVED
BLM AZ STATE OFFICE
2016 AUG - 3 P 1:44
PHOENIX, ARIZONA

***** FOR OFFICIAL USE ONLY *****
DATE _____ INITIALS _____ VERIFIED _____

**DEPARTMENT OF THE INTERIOR
BUREAU OF LAND MANAGEMENT
MINING CLAIMS
(MASS) Serial Register Page**

RunDate/Time:08/03/16 02:07 PM

Page: 1 of 2

01 10-21-1976;090STAT0090;43USC1744
Case Type 384201: PLACER CLAIM
Commodity:
Claim Name: HONEYBEE
Case Disposition: ACTIVE
Required Maintenance Fee: \$155.00

Total Acres
19.980

Serial Number
AMC203191
Lead File Number
AMC203191

Name & Address			Int Rel
JORDAN ROBERT	6262 E BROWN RD UNIT 42	MESA, AZ 85205-4846	CLAIMANT

County/State	District
YAVAPAI County, AZ	PHOENIX DO

Mer Twp	Rng	Sec	Subdivision
14	0092N	0020E	032 SE

Act Date	Code	Action Text	Action Remarks	Receipt Number
08/15/1983	403	LOCATION DATE		
08/16/1983	395	RECORDATION NOTICE RECD		
08/04/2015	782	MAINTENANCE FEE PAYMENT	2016;\$155	3359017
08/01/2014	782	MAINTENANCE FEE PAYMENT	2015;\$155	3091003
08/02/2013	682	MAINTENANCE FEE/\$140	2014;\$140	2845724
08/01/2012	682	MAINTENANCE FEE/\$140	2013;\$140	2620418
08/01/2011	682	MAINTENANCE FEE/\$140	2012	2394625
08/19/2010	682	MAINTENANCE FEE/\$140	2011	2195569
07/21/2009	682	MAINTENANCE FEE/\$140	2010	1962198
08/06/2008	582	MAINTENANCE FEE/\$125	2009	1755121
08/10/2007	582	MAINTENANCE FEE/\$125	2008	1540923
08/02/2006	582	MAINTENANCE FEE/\$125	2007	1326180
08/04/2005	582	MAINTENANCE FEE/\$125	2006	1122199
08/09/2004	582	MAINTENANCE FEE/\$125	2005	923828
08/04/2003	482	MAINTENANCE FEE/\$100	2004	722815
08/12/2002	482	MAINTENANCE FEE/\$100	2003	537786
08/02/2001	482	MAINTENANCE FEE/\$100	2002	348944
08/08/2000	482	MAINTENANCE FEE/\$100	2001	164829
08/16/1999	482	MAINTENANCE FEE/\$100	2000	
08/17/1998	482	MAINTENANCE FEE/\$100	1999	
08/18/1997	482	MAINTENANCE FEE/\$100	1998	
08/13/1996	482	MAINTENANCE FEE/\$100	1997	
08/08/1995	482	MAINTENANCE FEE/\$100	1996	
08/24/1994	482	MAINTENANCE FEE/\$100	1995	
08/26/1993	482	MAINTENANCE FEE/\$100	1994	
08/26/1993	482	MAINTENANCE FEE/\$100	1993;RECEIPT 2044702	
09/22/1992	480	EVID OF ASSMT FILED	1992	
08/08/2012	396	TRF OF INTEREST FILED	STOTT ARVIN	2633181
08/16/1999	113	ADDITIONAL INFO RECEIVED	RECEIPT 2296567	

NO WARRANTY IS MADE BY BLM
FOR USE OF THE DATA FOR
PURPOSES NOT INTENDED BY BLM

DEPARTMENT OF THE INTERIOR
BUREAU OF LAND MANAGEMENT
MINING CLAIMS
(MASS) Serial Register Page

RunDate/Time:08/03/16 02:07 PM

Page: 2 of 2

08/17/1998	113	ADDITIONAL INFO RECEIVED	RECEIPT 2389364
08/18/1997	113	ADDITIONAL INFO RECEIVED	RECEIPT 2315357
08/13/1996	113	ADDITIONAL INFO RECEIVED	RECEIPT 2228542
08/08/1995	113	ADDITIONAL INFO RECEIVED	RECEIPT 2147417
08/24/1994	113	ADDITIONAL INFO RECEIVED	RECEIPT 2024534
07/15/1988	669	LAND STATUS CHECKED	
08/16/1983	501	ACCT ADV IN LEAD FILE	AMC203191
08/15/1983	404	COUNTY RECORDATION	0;1560;141

Line Nr Remarks

United States Department of the Interior
Bureau of Land Management
 DIV OF LANDS, MINRLS & ENERGY
 ONE N CENTRAL AVE
 PHOENIX, AZ 85004 -4427
 Phone: 602-417-9200

Receipt

No: 3620694

Transaction #: 3724364	
Date of Transaction: 08/03/2016	
CUSTOMER:	
ROBERT JORDAN 6546 E ADOBE RD MESA, AZ 85205-6005 US	

LINE #	QTY	DESCRIPTION	REMARKS	UNIT PRICE	TOTAL
1	1.00	LOCATABLE MINERALS / MINING CLAIMS- NOT NEW-UNADJUD, ONE AUTH NO. ONLY / MINING CLAIM MONEY RECEIVED CASES: AMC203191/\$155.00	MAINT 2017/1	- n/a -	155.00
TOTAL:					\$155.00

PAYMENT INFORMATION			
NOTE: Items will appear on credit card statement as "Bureau of Land Mgmt CO".			
1	AMOUNT:	155.00	POSTMARKED: N/A
	TYPE:	CREDIT CARD	RECEIVED: 08/03/2016
	NAME:	JORDAN, ROBERT 6546 E ADOBE RD MESA AZ 85205-6005 US	
	CARD NO:	XXXXXXXXXXXX0723	AUTH CODE: 00082C
	NAME ON CARD:	ROBERT W JORDAN	
	EXPIRES:	07/2019	
	SIGNATURE:		

REMARKS
REC'D ER

This receipt was generated by the automated BLM Collections and Billing System and is a paper representation of a portion of the official electronic record contained therein.

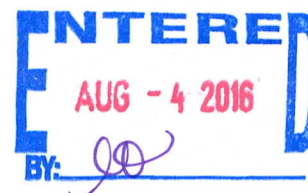

Run Date: 08/12/15

Run Time: 08:37 AM

**DEPARTMENT OF THE INTERIOR
BUREAU OF LAND MANAGEMENT
MINING CLAIMS**

MC Maintenance Fees Paid Through the BLM Pay Portal

CBS Receipt: 3359017

Printed For Lead File # **AMC203191**

Agency Tracking ID: 1438704573

Number of BLM Serial Nr: 1

Assessment Year: 2016

Total Amount Paid: \$155.00

Paid On: 08/04/2015

Claim Name	BLM Serial No	Lead File No	Amount Paid
HONEYBEE	AMC203191	AMC203191	\$155.00

United States Department of the Interior
Bureau of Land Management
 BUSINESS & SUPPORT SVCS DIV
 ONE N CENTRAL AVE SUITE 800
 PHOENIX, AZ 85004 -4427
 Phone: (602) 417-9200

Receipt

No: 3359017

Transaction #: 3456984	
Date of Transaction: 08/04/2015	
CUSTOMER:	
ROBERT JORDAN 6546 E ADOBE RD MESA, AZ 85205 US	

LINE #	QTY	DESCRIPTION	REMARKS	UNIT PRICE	TOTAL
1	1.00	LOCATABLE MINERALS / MINING CLAIMS- NOT NEW-UNADJUD, ONE AUTH NO. ONLY / MINING CLAIM MONEY RECEIVED CASES: AMC203191 /\$155.00		- n/a -	155.00
TOTAL:					\$155.00

PAYMENT INFORMATION			
NOTE: Items will appear on credit card statement as "BLM O Mining Claim".			
1	AMOUNT:	155.00	POSTMARKED: N/A
	TYPE:	CREDIT CARD	RECEIVED: 08/04/2015
	NAME:	ROBERT JORDAN 6546 E ADOBE RD MESA AZ 85205 US	
	CARD NO:	XXXXXXXXXXXX0723	AUTH CODE: 03600C
	NAME ON CARD:	ROBERT JORDAN	
	EXPIRES:	07/2017	
	SIGNATURE:		

REMARKS

This receipt was generated by the automated BLM Collections and Billing System and is a paper representation of a portion of the official electronic record contained therein.

UNITED STATES
DEPARTMENT OF THE INTERIOR
BUREAU OF LAND MANAGEMENT

AMC 203191

CREDIT CARD PAYMENT
For Mining Claim Maintenance Fee

THIS IS A CHANGE OF ADDRESS

TELEPHONE SUBMISSION - ACCURACY OF THE BELOW INFORMATION IS THE RESPONSIBILITY OF THE CLAIMANT/OWNER

NAME Robert JORDAN
ADDRESS 6546 E ADOBE RD
CITY MESA STATE AZ ZIP 85205-6005
PHONE # 480 - 985-5550

SEND RECEIPT TO Above address
 Other (Include Name and Mailing Address):

AMC NUMBER
203191

CLAIM/SITE NAME
Honey Bee

1 # of Claim/Site
x 155.00 Each
\$ 155 Total Charged CJM (INITIALS)

RECEIPT # 3091003

DATE STAMP

RECEIVED
BLM AZ STATE OFFICE
2014 AUG - 1 P. 3: 37
PHOENIX, ARIZONA

ENTERED
AUG - 5 2014
BY: RAJ

**** FOR OFFICIAL USE ONLY ****
DATE _____ INITIALS _____ VERIFIED _____

United States Department of the Interior
Bureau of Land Management
 LANDS/RECREATION & PLANNING
 ONE N CENTRAL AVE
 PHOENIX, AZ 85004 -2203
 Phone: 602-417-9200

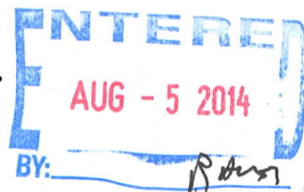

Receipt

No: 3091003

Transaction #: 3182404	
Date of Transaction: 08/01/2014	
CUSTOMER:	
ROBERT JORDAN 6546 E ADOBE RD MESA, AZ 85205-6005 US	

LINE #	QTY	DESCRIPTION	REMARKS	UNIT PRICE	TOTAL
1	1.00	LOCATABLE MINERALS / MINING CLAIMS- NOT NEW-UNADJUD, ONE AUTH NO. ONLY / MINING CLAIM MONEY RECEIVED CASES: AMC203191/\$155.00	MAINT 2015/1	- n/a -	155.00
TOTAL:					\$155.00

PAYMENT INFORMATION			
NOTE: Items will appear on credit card statement as "Bureau of Land Mgmt CO".			
1	AMOUNT:	155.00	POSTMARKED: N/A
	TYPE:	CREDIT CARD	RECEIVED: 08/01/2014
	NAME:	JORDAN, ROBERT 6546 E ADOBE RD MESA AZ 85205-6005 US	
	CARD NO:	XXXXXXXXXXXX0723	AUTH CODE: 07288C
	NAME ON CARD:	ROBERT W JORDAN	
	EXPIRES:	07/2017	
	SIGNATURE:		

REMARKS

This receipt was generated by the automated BLM Collections and Billing System and is a paper representation of a portion of the official electronic record contained therein.

UNITED STATES
DEPARTMENT OF THE INTERIOR
BUREAU OF LAND MANAGEMENT

203191
262634

CREDIT CARD PAYMENT
For Mining Claim Maintenance Fee

THIS IS A CHANGE OF ADDRESS

TELEPHONE SUBMISSION - ACCURACY OF THE BELOW INFORMATION IS THE RESPONSIBILITY OF THE CLAIMANT/OWNER

NAME ROBERT JORDANN
ADDRESS 6546 E. ADOBE RD
CITY MESA STATE AZ ZIP 85205-6005
PHONE # 480 - 985-5550

SEND RECEIPT TO Above address
 Other (include Name and Mailing Address):

AMC NUMBER
203191
262638

CLAIM/SITE NAME
Howey BEE
DS 10

2 # of Claim/Site
x 140.00 Each
\$ 280.00 Total Charged RM (INITIALS)

RECEIPT # 2845724

DATE STAMP

RECEIVED
BLMAZ STATE OFFICE
2013 AUG - 2 A 10: 01
PHOENIX, ARIZONA

***** FOR OFFICIAL USE ONLY *****

DATE 8-12-13 INITIALS BE VERIFIED _____

United States Department of the Interior
 Bureau of Land Management
 LANDS/RECREATION & PLANNING
 ONE N CENTRAL AVE
 PHOENIX, AZ 85004 -2203
 Phone: 602-417-9200

Receipt

No:

2845724

Transaction #: 2931376	
Date of Transaction: 08/02/2013	
CUSTOMER:	
ROBERT JORDANN 6546 E ADOBE RD MESA, AZ 85205-6005 US	

LINE #	QTY	DESCRIPTION	REMARKS	UNIT PRICE	TOTAL
1	1.00	LOCATABLE MINERALS / MINING CLAIMS-NOT NEW-UNADJUD, ONE AUTH NO. ONLY / MINING CLAIM MONEY RECEIVED CASES: AMC203191/\$280.00	MAINT 2014/2	- n/a -	280.00
TOTAL:					\$280.00

PAYMENT INFORMATION			
NOTE: Items will appear on credit card statement as "Bureau of Land Mgmt CO".			
1	AMOUNT:	280.00	POSTMARKED: N/A
	TYPE:	CREDIT CARD	RECEIVED: 08/02/2013
	NAME:	JORDANN, ROBERT 6546 E ADOBE RD MESA AZ 85205-6005 US	
	CARD NO:	XXXXXXXXXXXX0723	AUTH CODE: 06441C
	NAME ON CARD:	ROBERT W JORDANN	
	EXPIRES:	07/2014	
	SIGNATURE:		

REMARKS

This receipt was generated by the automated BLM Collections and Billing System and is a paper representation of a portion of the official electronic record contained therein.

UNITED STATES
DEPARTMENT OF THE INTERIOR
BUREAU OF LAND MANAGEMENT

AMC 203191
AMC 26263A

CREDIT CARD PAYMENT
For Mining Claim Maintenance Fee

THIS IS A CHANGE OF ADDRESS

TELEPHONE SUBMISSION - ACCURACY OF THE BELOW INFORMATION IS THE RESPONSIBILITY OF THE CLAIMANT/OWNER

NAME Robert Jordan
ADDRESS 6546 E. Adobe Rd
CITY Mesa STATE AZ ZIP 85205 - 6005
PHONE # 480 - 985 5550

SEND RECEIPT TO Above address
 Other (Include Name and Mailing Address):

AMC NUMBER
203191
262638

CLAIM/SITE NAME
Honey Bee
DJ 10

2 of Claim/Site
@ 140.00 Each
\$ 280 Total Charged RAH (INITIALS)

RECEIPT # 2620418

DATE STAMP

RECEIVED
BLM AZ STATE OFFICE
2012 AUG - 1 A 9:32
PHOENIX, ARIZONA

ENTERED IN COMPUTER

RS 8.14.12

***** FOR OFFICIAL USE ONLY *****

DATE _____ INITIALS _____ VERIFIED _____

**United States Department of the Interior
Bureau of Land Management
LANDS/RECREATION & PLANNING
ONE N CENTRAL AVE
PHOENIX, AZ 85004 -2203
Phone: 602-417-9200**

Receipt

No: 2620418

Transaction #: 2700755	
Date of Transaction: 08/01/2012	
CUSTOMER:	
ROBERT JORDAN 6546 E ADOBE RD MESA, AZ 85205-6005 US	

LINE #	QTY	DESCRIPTION	REMARKS	UNIT PRICE	TOTAL
1	1.00	LOCATABLE MINERALS / MINING CLAIMS- NOT NEW-UNADJUD, ONE AUTH NO. ONLY / MINING CLAIM MONEY RECEIVED CASES: AMC203191/\$280.00	MAINT 2013 / 2	- n/a -	280.00
TOTAL:					\$280.00

PAYMENT INFORMATION			
NOTE: Items will appear on credit card statement as "Bureau of Land Mgmt CO".			
1	AMOUNT:	280.00	POSTMARKED: N/A
	TYPE:	CREDIT CARD	RECEIVED: 08/01/2012
	NAME:	JORDAN, ROBERT 6546 E ADOBE RD MESA AZ 85205-6005 US	
	CARD NO:	XXXXXXXXXXXX2553	AUTH CODE: 08630C
	NAME ON CARD:	ROBERT W JORDAN	
	EXPIRES:	07/2014	
	SIGNATURE:		

REMARKS

This receipt was generated by the automated BLM Collections and Billing System and is a paper representation of a portion of the official electronic record contained therein.

UNITED STATES
DEPARTMENT OF THE INTERIOR
BUREAU OF LAND MANAGEMENT

Amc 203191
Amc 262634

CREDIT CARD PAYMENT
FOR MINING CLAIM MAINTENANCE FEE

NAME Robert Jordan

ADDRESS 6546 E. Adobe Rd.

CITY Mesa STATE AZ ZIP 85205

PHONE # (480) 985-5550

[] THIS IS A CHANGE OF ADDRESS

AMC NUMBER

CLAIM/SITE NAME

203191

Honey Bee

262638

DJ #10

DATE STAMP

COUNT 2 \$ 280 INITIALS TMC

TELEPHONE SUBMISSION - ACCURACY OF THE ABOVE INFORMATION
IS THE RESPONSIBILITY OF THE CLAIMANT/OWNER

FOR OFFICIAL USE ONLY

DATE

INITIALS

VERIFIED

PHOENIX, ARIZONA

2011 AUG - 1 A 10:13

RECEIVED
BLM AZ STATE OFFICE

AUG 8 2011 cm

2394625

United States Department of the Interior
Bureau of Land Management
 LANDS/RECREATION & PLANNING
 ONE N CENTRAL AVE
 PHOENIX, AZ 85004 -2203
 Phone: 602-417-9200

Receipt

No: 2394625

Transaction #: 2469724	
Date of Transaction: 08/02/2011	
CUSTOMER:	
ROBERT JORDAN 6546 E ADOBE RD MESA, AZ 85205-6005 US	

LINE #	QTY	DESCRIPTION	REMARKS	UNIT PRICE	TOTAL
1	1.00	LOCATABLE MINERALS / MINING CLAIMS-NOT NEW-UNADJUD, ONE AUTH NO. ONLY / MINING CLAIM MONEY RECEIVED CASES: AMC203191/\$280.00	MAINT 2012/2	- n/a -	280.00
TOTAL:					\$280.00

PAYMENT INFORMATION			
NOTE: Items will appear on credit card statement as "Bureau of Land Mgmt CO".			
1	AMOUNT:	280.00	POSTMARKED: N/A
	TYPE:	CREDIT CARD	RECEIVED: 08/02/2011
	NAME:	JORDAN, ROBERT 6546 E ADOBE RD MESA AZ 85205-6005 US	
	CARD NO:	XXXXXXXXXXXX2553	AUTH CODE: 09736D
	NAME ON CARD:	ROBERT JORDAN	
	EXPIRES:	07/2014	
	SIGNATURE:		

REMARKS

This receipt was generated by the automated BLM Collections and Billing System and is a paper representation of a portion of the official electronic record contained therein.

UNITED STATES
DEPARTMENT OF THE INTERIOR
BUREAU OF LAND MANAGEMENT

AMC 203191
AMC 262634

CREDIT CARD PAYMENT
For Mining Claim Maintenance Fee

THIS IS A CHANGE OF ADDRESS

TELEPHONE SUBMISSION - ACCURACY OF THE BELOW INFORMATION IS THE RESPONSIBILITY OF THE CLAIMANT/OWNER

NAME Robert Jordan
ADDRESS 6546 E Adobe Rd.
CITY Mesa STATE AZ ZIP 85205-6005
PHONE # 480 - 985-5550

SEND RECEIPT TO Above address
 Other (Include Name and Mailing Address):

ENTERED INTO COMPU

AUG 27 2010

AMC NUMBER

203191
262638

CLAIM/SITE NAME

Honey Bee
DJ 10

2 # of Claim/Site
x 140.00 Each
\$ 280.00 Total Charged (INITIALS)

RECEIPT # 2195569

DATE STAMP

PHOENIX, ARIZONA

2010 AUG - 3 A 9:03

RECEIVED
BLM AZ STATE OFFICE

***** FOR OFFICIAL USE ONLY *****

DATE _____ INITIALS _____ VERIFIED _____

United States Department of the Interior
Bureau of Land Management
 LANDS/RECREATION & PLANNING
 ONE N CENTRAL AVE
 PHOENIX, AZ 85004 -2203
 Phone:

Receipt

No: 2195569

Transaction #: 2265402	
Date of Transaction: 08/19/2010	
CUSTOMER:	ROBERT JORDAN 6546 E ADOBE RD MESA, AZ 85205-6005 US

ENTERED INTO COMPUTER
AUG 27 2010

LINE #	QTY	DESCRIPTION	REMARKS	UNIT PRICE	TOTAL
1	1.00	LOCATABLE MINERALS / MINING CLAIMS- NOT NEW-UNADJUD, ONE AUTH NO. ONLY / MINING CLAIM MONEY RECEIVED CASES: AMC203191/\$280.00	2011 MAINT (2)	- n/a -	280.00
TOTAL:					\$280.00

PAYMENT INFORMATION			
NOTE: Items will appear on credit card statement as "Bureau of Land Mgmt CO".			
1	AMOUNT:	280.00	POSTMARKED: N/A
	TYPE:	CREDIT CARD	RECEIVED: 08/19/2010
	NAME:	JORDAN, ROBERT 6546 E ADOBE RD MESA AZ 85205-6005 US	
	CARD NO:	XXXXXXXXXXXX0658	AUTH CODE: 05550C
	NAME ON CARD:	ROBERT W JORDAN	
	EXPIRES:	07/2012	
	SIGNATURE:		

REMARKS

This receipt was generated by the automated BLM Collections and Billing System and is a paper representation of a portion of the official electronic record contained therein.

AMC 203191
262634

UNITED STATES
DEPARTMENT OF THE INTERIOR
BUREAU OF LAND MANAGEMENT

CREDIT CARD PAYMENT
For Mining Claim Maintenance Fee

THIS IS A CHANGE OF ADDRESS

TELEPHONE SUBMISSION - ACCURACY OF THE BELOW INFORMATION IS THE RESPONSIBILITY OF THE CLAIMANT/OWNER

NAME Robert Jordan
ADDRESS 6546 E Adobe Rd
CITY Mesa STATE _____ ZIP 85205-
PHONE # 480 - 985 5550 6005

SEND RECEIPT TO Above address
 Other (Include Name and Mailing Address):

AMC NUMBER
203191
262638

CLAIM/SITE NAME
Honey bee
D. J. # 10

2 # of Claim/Site
x 140.00 Each
\$ 280.00 Total Charged SL (INITIALS)

RECEIVED
BLM AZ STATE OFFICE
2009 JUL 21 P 1:25
PHOENIX, ARIZONA

***** FOR OFFICIAL USE ONLY *****
DATE _____ INITIALS _____ VERIFIED _____

ENTERED INTO COMPUTER
7/27/09 099

United States Department of the Interior

Bureau of Land Management
 BUSINESS & SUPPORT SVCS DIV
 ONE N CENTRAL AVE SUITE 800
 PHOENIX, AZ 85004 -4427
 Phone: (602) 417-9200

Receipt

No: 1962198

Transaction #: 2025942	
Date of Transaction: 07/22/2009	
CUSTOMER:	ROBERT JORDAN 6546 E ADOBE RD MESA, AZ 85205-6005 US

LINE #	QTY	DESCRIPTION	REMARKS	UNIT PRICE	TOTAL
1	1.00	LOCATABLE MINERALS / MINING CLAIMS-NOT NEW-UNADJUD, ONE AUTH NO. ONLY / MINING CLAIM MONEY RECEIVED CASES: AMC203191/\$280.00	MAINT 2010 (2)	- n/a -	280.00
TOTAL:					\$280.00

PAYMENT INFORMATION			
NOTE: Items will appear on credit card statement as "Bureau of Land Mgmt CO".			
1	AMOUNT:	280.00	POSTMARKED: N/A
	TYPE:	CREDIT CARD	RECEIVED: 07/22/2009
	NAME:	JORDAN, ROBERT 6546 E ADOBE RD MESA AZ 85205-6005 US	
	CARD NO:	XXXXXXXXXXXX1012	AUTH CODE: 188869
	NAME ON CARD:	ROBERT W JORDAN	
	EXPIRES:	06/2010	
	SIGNATURE:		

REMARKS

This receipt was generated by the automated BLM Collections and Billing System and is a paper representation of a portion of the official electronic record contained therein.

Amc 203191
Amc 262634

UNITED STATES
DEPARTMENT OF THE INTERIOR
BUREAU OF LAND MANAGEMENT

CREDIT CARD PAYMENT
FOR MINING CLAIM MAINTENANCE FEE

NAME Robert JORDAN

ADDRESS 6546 E ADOBE RD

CITY MESA STATE AZ ZIP 85205-6005

PHONE # (480) 985-5550

SEND RECEIPT TO ABOVE ADDRESS
SEND RECEIPT TO: _____

AMC NUMBER

CLAIM/SITE NAME

203191

Honey Bee

262638

DJ 10

ENTERED INTO COMPUTER

SEP 02 2008 AB

DATE STAMP

TELEPHONE SUBMISSION - ACCURACY OF THE ABOVE INFORMATION
IS THE RESPONSIBILITY OF THE CLAIMANT/OWNER

FOR OFFICIAL USE ONLY

DATE _____ INITIALS _____ VERIFIED _____

COUNT 2 \$ 250.00 INITIALS EBG

PHOENIX, ARIZONA
2008 AUG - 9 - 10:17
RECEIVED B.L.M. AZ STATE OFFICE

United States Department of the Interior
Bureau of Land Management
 BUSINESS & SUPPORT SVCS DIV
 ONE N CENTRAL AVE SUITE 800
 PHOENIX, AZ 85004 -4427
 Phone: (602) 417-9200

Receipt

No: 1755121

Transaction #: 1812498		ENTERED INTO COMPUTER
Date of Transaction: 08/06/2008		
CUSTOMER:	ROBERT JORDAN 6546 E ADOBE RD MESA, AZ 85205	SEP 02 2008 PB + VERIFIED

LINE #	QTY	DESCRIPTION	REMARKS	UNIT PRICE	TOTAL
1	1.00	LOCATABLE MINERALS / MINING CLAIMS- NOT NEW-UNADJUD, ONE AUTH NO. ONLY / MINING CLAIM MONEY RECEIVED (455) CASES: AMC203191/\$250.00	2009 MAINT (2)	- n/a -	250.00
TOTAL:					\$250.00

PAYMENT INFORMATION			
NOTE: Items will appear on credit card statement as "Bureau of Land Mgmt CO".			
1	AMOUNT:	\$250.00	POSTMARKED: N/A
	TYPE:	CREDIT CARD	RECEIVED: 08/06/2008
	NAME:	JORDAN, ROBERT 6546 E ADOBE RD MESA AZ 85205	
	CARD NO:	XXXXXXXXXXXX9336	AUTH CODE: 76145Z
	NAME ON CARD:	ROBERT W JORDAN	
	EXPIRES:	05/31/2009	
	SIGNATURE:		

REMARKS

This receipt was generated by the automated BLM Collections and Billing System and is a paper representation of a portion of the official electronic record contained therein.

UNITED STATES
DEPARTMENT OF THE INTERIOR
BUREAU OF LAND MANAGEMENT

AMC 203191
AMC 262634

CREDIT CARD PAYMENT 2008
FOR MINING CLAIM MAINTENANCE FEE

NAME Robert JORDAN

ADDRESS 6546 E Adobe Road

CITY Mesa STATE AZ ZIP 85205-6005

PHONE # (480) 985-5550

SEND RECEIPT TO ABOVE ADDRESS
SEND RECEIPT TO: _____

AMC NUMBER
AMC 203191
262638

CLAIM/SITE NAME
Honey Bee
DJ10

DATE STAMP

RECEIVED
B.L.M. AZ STATE OFFICE
2007 AUG -3 A 11: 51
PHOENIX, ARIZONA

TELEPHONE SUBMISSION - ACCURACY OF THE ABOVE INFORMATION
IS THE RESPONSIBILITY OF THE CLAIMANT/OWNER

FOR OFFICIAL USE ONLY
8/17/07 RE
DATE INITIALS VERIFIED

COUNT 2 \$ 250.00 INITIALS EG

#1540923

United States Department of the Interior
Bureau of Land Management
 BUSINESS & SUPPORT SVCS DIV
 ONE N CENTRAL AVE SUITE 800
 PHOENIX, AZ 85004 -4427
 Phone: (602) 417-9200

Receipt

No: 1540923

Transaction #: 1592251	
Date of Transaction: 08/10/2007	
CUSTOMER:	ROBERT JORDAN 6546 E ADOBE RD MESA,AZ 85205

LINE #	QTY	DESCRIPTION	REMARKS	UNIT PRICE	TOTAL
1	1.00	LOCATABLE MINERALS / MINING CLAIMS- NOT NEW-UNADJUD,ONE AUTH NO. ONLY / MINING CLAIM MONEY RECEIVED (455) CASES: AMC203191/\$250.00	MAINT 2008/2	- n/a -	250.00
TOTAL:					\$250.00

PAYMENT INFORMATION					
NOTE: Items will appear on credit card statement as "Bureau of Land Management".					
1	AMOUNT:	\$250.00	POSTMARKED:	N/A	
	TYPE:	CREDIT CARD	RECEIVED:	08/10/2007	
	NAME:	JORDAN, ROBERT 6546 E ADOBE RD MESA AZ 85205			
	CARD NO:	XXXXXXXXXXXX9314	AUTH CODE:	75895B	
	NAME ON CARD:	ROBERT JORDAN			
	EXPIRES:	05/31/2009			
	SIGNATURE:				

REMARKS

This receipt was generated by the automated BLM Collections and Billing System and is a paper representation of a portion of the official electronic record contained therein.

United States Department of the Interior
Bureau of Land Management
 BUSINESS & SUPPORT SVCS DIV
 ONE N CENTRAL AVE
 PHOENIX, AZ 85004 -2203
 Phone: (602) 417-9200

Receipt

No: 1326180

Transaction #: 1371128	
Date of Transaction: 08/02/2006	
CUSTOMER:	ROBERT JORDAN 6546 E ADOBE RD MESA, AZ 85205

AMC 262634
AMC 203191

LINE #	QTY	DESCRIPTION	REMARKS	UNIT PRICE	TOTAL
1	1.00	LOCATABLE MINERALS / MINING CLAIMS-NOT NEW-UNADJUD, ONE AUTH NO. ONLY / MINING CLAIM MONEY RECEIVED (455) CASES: AMC203191/\$250.00	MAINT 2007 (2)	- n/a -	250.00
TOTAL:					\$250.00

PAYMENT INFORMATION					
1	AMOUNT:	\$250.00	POSTMARKED:	N/A	
	TYPE:	CHECK	RECEIVED:	08/02/2006	
	CHECK NO:	4775			
	NAME:	JORDAN, ROBERT 6546 E ADOBE RD MESA AZ 85205			

REMARKS

This receipt was generated by the automated BLM Collections and Billing System and is a paper representation of a portion of the official electronic record contained therein.

RE 8/2/06

\$125.00

MAINTENANCE FEE PAYMENT

~~\$100.00~~ MAINTENANCE FEE PAYMENT DUE ON OR BEFORE AUGUST 31, ~~19 2006~~
IN LIEU OF ASSESSMENT WORK FOR THE UPCOMING ASSESSMENT
YEAR BEGINNING SEPTEMBER 1 OF THE YEAR NOTED ABOVE.

BUREAU OF LAND MANAGEMENT
ARIZONA STATE OFFICE
222 NORTH CENTRAL AVENUE
PHOENIX, AZ 85004

COUNT: 2 \$ 250 INT: FR FOR
OFFICIAL USE ONLY

THE CLAIMS ARE SITUATED IN YAVAPAI COUNTY, ARIZONA.

BLM SERIAL NUMBERS

NAMES OF CLAIMS OR SITES

A MC _____ THRU A MC _____
COUNTY BOOK/DOCKET _____, PAGE(S) OR FEE NO(S) _____

A MC _____ THRU A MC _____
COUNTY BOOK/DOCKET _____, PAGE(S) OR FEE NO(S) _____

(OR) IF NOT CONSECUTIVE NUMBERS LIST SEPARATELY BELOW:

BLM SERIAL NUMBERS	NAME OF CLAIMS/SITES	COUNTY BOOK/DOCKET & PAGE OR FEE NUMBER
A MC <u>203191</u>	<u>HONEYBEE</u>	<u>2541/191</u>
A MC <u>262638</u>	<u>DI-10</u>	<u>2713/239</u>
A MC _____	_____	_____
A MC _____	_____	_____
A MC _____	_____	_____
A MC _____	_____	_____
A MC _____	_____	_____
A MC _____	_____	_____
A MC _____	_____	_____
A MC _____	_____	_____
A MC _____	_____	_____
A MC _____	_____	_____

CLAIMANT'S NAME: ROBERT JORDAN

ADDRESS: 6546 E. ADAMS CITY: MESA STATE: AZ ZIP: 85205

CHECK HERE IF THIS PHONE: 480 985-5350
IS A CHANGE OF ADDRESS

SIGNATURE: Robert Jordan
TO RECORD WITH THE COUNTY, ONE CLAIMANT OR THE AGENT MUST SIGN

LIST ALL ADDITIONAL OWNERS ON REVERSE SIDE OF THIS FORM
FOR OFFICIAL USE ONLY
ENTERED INTO COMPUTER: 8/4/06 RF
DATE INITIALS VERIFIED

RECEIVED
BLM, AZ STATE OFFICE
PHOENIX, ARIZONA
2006 AUG -2 A 10:56
TIME STAMP

**United States Department of the Interior
Bureau of Land Management**

BUSINESS & SUPPORT SVCS DIV
222 N CENTRAL AVE
PHOENIX, AZ 85004 -2203
Phone: (602) 417-9200

Receipt	
No:	1122199

Transaction #: 1161133
Date of Transaction: 08/04/2005

AMC 203191
AMC 262634

CUSTOMER: ROBERT JORDAN
6546 E ADOBE RD
MESA, AZ 85205

LINE #	QTY	DESCRIPTION	REMARKS	UNIT PRICE	TOTAL
1	1.00	LOCATABLE MINERALS / MINING CLAIMS-NOT NEW-UNADJUD, ONE AUTH NO. ONLY / MINING CLAIM MONEY RECEIVED (455) CASES: AMC203191/\$250.00	MAINT 2006 -2	- n/a -	250.00
TOTAL:					\$250.00

PAYMENT INFORMATION			
NOTE: Items will appear on credit card statement as "Bureau of Land Management".			
1	AMOUNT:	\$250.00	POSTMARKED: N/A
	TYPE:	CREDIT CARD	RECEIVED: 08/04/2005
	NAME:	JORDAN, ROBERT 6546 E ADOBE RD MESA AZ 85205	
	CARD NO:	XXXXXXXXXXXX2769	AUTH CODE: 848066
	NAME ON CARD:	ROBERT JORDAN	
	EXPIRES:	08/31/2006	
	SIGNATURE:		

REMARKS

This receipt was generated by the automated BLM Collections and Billing System and is a paper representation of a portion of the official electronic record contained therein.

ENTERED IN COMPUTER

RS 8/15/05

UNITED STATES
DEPARTMENT OF THE INTERIOR
BUREAU OF LAND MANAGEMENT

CREDIT CARD PAYMENT
FOR MINING CLAIM MAINTENANCE FEE

NAME Robert W. JORDAN
ADDRESS 6546 E ADOBE RD
CITY MESA STATE AZ ZIP 85205
PHONE # (480) 985-5550

AMC NUMBER
203191
262638

CLAIM/SITE NAME
HONEY BEE
DJ #10

DATE STAMP

TELEPHONE SUBMISSION - ACCURACY OF THE ABOVE INFORMATION
IS THE RESPONSIBILITY OF THE CLAIMANT/OWNER

FOR OFFICIAL USE ONLY

8/4/05 EC _____
DATE INITIALS VERIFIED

COUNT 2 \$ 250⁰⁰ INITIALS EC

PHOENIX, ARIZONA
2005 AUG -4 A 10: 33
RECEIVED
B.L.M. AZ STATE OFFICE

ENTERED IN COMPUTER

RS 8/15/05

Amc 203191

Amc 262634

MAINTENANCE FEE PAYMENT

\$100.00 MAINTENANCE FEE PAYMENT DUE ON OR BEFORE AUGUST 31, ~~2004~~
IN LIEU OF ASSESSMENT WORK FOR THE UPCOMING ASSESSMENT
YEAR BEGINNING SEPTEMBER 1 OF THE YEAR NOTED ABOVE.

Bureau Of Land Management
Arizona State Office
222 North Central Avenue
Phoenix, AZ. 85004-2203

CC	# 923828	
COUNT: 2	\$ 250 ⁰⁰	INT: (VA)
FOR OFFICIAL USE ONLY		

THE CLAIMS ARE SITUATED IN YAVAPAI COUNTY, ARIZONA.

BLM SERIAL NUMBERS _____ NAMES OF CLAIMS OR SITES _____

A MC _____ THRU A MC _____

COUNTY BOOK/DOCKET _____, PAGE(S) OR FEE NO(S) _____

A MC _____ THRU A MC _____

COUNTY BOOK/DOCKET _____, PAGE(S) OR FEE NO(S) _____

(OR) IF NOT CONSECUTIVE NUMBERS LIST SEPARATELY BELOW:

BLM SERIAL NUMBERS	NAME OF CLAIMS/SITES	COUNTY BOOK/DOCKET & PAGE OR FEE NUMBER
A MC <u>203191</u>	<u>HONEY BEE</u>	<u>2541/191</u>
A MC <u>262638</u>	<u>DJ-10</u> <u>262634</u>	<u>2713/239</u>
A MC _____	_____	_____
A MC _____	_____	_____
A MC _____	_____	_____
A MC _____	_____	_____
A MC _____	_____	_____
A MC _____	_____	_____
A MC _____	_____	_____

RECEIVED
 B.L.M. AZ STATE OFFICE
 2004 AUG - 9 A 10 12
 PHOENIX, ARIZONA

CLAIMANT'S NAME: ROBERT JORDAN

ADDRESS: 6546 EAST ADOBE RD CITY: MESA STATE: AZ

CHECK HERE IF THIS IS A CHANGE OF ADDRESS PHONE: 480 985-5550 ZIP: 85205

SIGNATURE: Robert Jordan
TO RECORD WITH THE COUNTY, ONE CLAIMANT OR THE AGENT MUST SIGN

ENTERED INTO COMPUTER
SEP 10 2004 PR

LIST ALL ADDITIONAL OWNERS ON REVERSE SIDE OF THIS FORM

FOR OFFICIAL USE ONLY

United States Department of the Interior
Bureau of Land Management
 BUSINESS & SUPPORT SVCS DIV
 222 N CENTRAL AVE
 PHOENIX, AZ 85004 -2203
 Phone: (602) 417-9200

Receipt	
No:	923828

Transaction #: 957958
Date of Transaction: 08/09/2004
CUSTOMER: ROBERT JORDAN 6546 E ADOBE RD MESA, AZ 85205

LINE #	QTY	DESCRIPTION	REMARKS	UNIT PRICE	TOTAL
1	1.00	LOCATABLE MINERALS / MINING CLAIMS-NOT NEW-UNADJUD, ONE AUTH NO. ONLY / MINING CLAIM MONEY RECEIVED (455) CASES: AMC203191/\$250.00	MAINT 2005/2	- n/a -	250.00
TOTAL:					\$250.00

PAYMENT INFORMATION																													
NOTE: Items will appear on credit card statement as "Bureau of Land Management".																													
1	<table border="1"> <tr> <td>AMOUNT:</td> <td>\$250.00</td> <td>POSTMARKED:</td> <td>N/A</td> </tr> <tr> <td>TYPE:</td> <td>CREDIT CARD</td> <td>RECEIVED:</td> <td>08/09/2004</td> </tr> <tr> <td>NAME:</td> <td colspan="3">JORDAN, ROBERT 6546 E ADOBE RD MESA AZ 85205</td> </tr> <tr> <td>CARD NO:</td> <td>XXXXXXXXXXXX2769</td> <td>AUTH CODE:</td> <td>260604</td> </tr> <tr> <td>NAME ON CARD:</td> <td colspan="3">JORDAN/ROBERT W</td> </tr> <tr> <td>EXPIRES:</td> <td colspan="3">08/31/2006</td> </tr> <tr> <td>SIGNATURE:</td> <td colspan="3"></td> </tr> </table>	AMOUNT:	\$250.00	POSTMARKED:	N/A	TYPE:	CREDIT CARD	RECEIVED:	08/09/2004	NAME:	JORDAN, ROBERT 6546 E ADOBE RD MESA AZ 85205			CARD NO:	XXXXXXXXXXXX2769	AUTH CODE:	260604	NAME ON CARD:	JORDAN/ROBERT W			EXPIRES:	08/31/2006			SIGNATURE:			
AMOUNT:	\$250.00	POSTMARKED:	N/A																										
TYPE:	CREDIT CARD	RECEIVED:	08/09/2004																										
NAME:	JORDAN, ROBERT 6546 E ADOBE RD MESA AZ 85205																												
CARD NO:	XXXXXXXXXXXX2769	AUTH CODE:	260604																										
NAME ON CARD:	JORDAN/ROBERT W																												
EXPIRES:	08/31/2006																												
SIGNATURE:																													

REMARKS

This receipt was generated by the automated BLM Collections and Billing System and is a paper representation of a portion of the official electronic record contained therein.

DMC 203191
AMC 262634

MAINTENANCE FEE PAYMENT

\$100.00 MAINTENANCE FEE PAYMENT DUE ON OR BEFORE AUGUST 31, 2003
IN LIEU OF ASSESSMENT WORK FOR THE UPCOMING ASSESSMENT
YEAR BEGINNING SEPTEMBER 1 OF THE YEAR NOTED ABOVE.

Bureau Of Land Management
Arizona State Office
222 North Central Avenue
Phoenix, AZ. 85004-2203

CASH # 722815	
COUNT: 2	\$ 200.00 INT.
FOR OFFICIAL USE ONLY	

THE CLAIMS ARE SITUATED IN YAVAPAI COUNTY, ARIZONA.

BLM SERIAL NUMBERS NAMES OF CLAIMS OR SITES

A MC _____ THRU A MC _____

COUNTY BOOK/DOCKET _____, PAGE(S) OR FEE NO(S) _____

A MC _____ THRU A MC _____

COUNTY BOOK/DOCKET _____, PAGE(S) OR FEE NO(S) _____

(OR) IF NOT CONSECUTIVE NUMBERS LIST SEPARATELY BELOW:

BLM SERIAL NUMBERS	NAME OF CLAIMS/SITES	COUNTY BOOK/DOCKET & PAGE OR FEE NUMBER
A MC <u>203191</u>	<u>HONEYBEE</u>	<u>2541/191</u>
A MC <u>262638</u>	<u>DS-10</u>	<u>2713/239</u>
A MC _____	_____	_____
A MC _____	_____	_____
A MC _____	_____	_____
A MC _____	_____	_____
A MC _____	_____	_____
A MC _____	_____	_____
A MC _____	_____	_____

RECEIVED
BLM AZ STATE OFFICE
2003 AUG -4 A 11:08
PHOENIX, ARIZONA

8/13/2003
ENTERED INTO COMPUTER

CLAIMANT'S NAME: ROBERT JORDAN
ADDRESS: 6546 E. ADIBE RD. CITY: MESA STATE: AZ.

CHECK HERE IF THIS IS A CHANGE OF ADDRESS PHONE: (480) 985-5560 ZIP: 85205

SIGNATURE: Robert Jordan
TO RECORD WITH THE COUNTY, ONE CLAIMANT OR THE AGENT MUST SIGN

TIME STAMP

LIST ALL ADDITIONAL OWNERS ON REVERSE SIDE OF THIS FORM

FOR OFFICIAL USE ONLY

YES

United States Department of the Interior
Bureau of Land Management
 BUSINESS & SUPPORT SVCS DIV
 222 N CENTRAL AVE
 PHOENIX, AZ 85004 -2203
 Phone: (602) 417-9200

Receipt	
No:	722815

Transaction #: 752053
Date of Transaction: 08/04/2003
CUSTOMER: ROBERT JORDAN 6546 E ADOBE RD MESA, AZ 85205

LINE #	QTY	DESCRIPTION	REMARKS	UNIT PRICE	TOTAL
1	1.00	LOCATABLE MINERALS / MINING CLAIMS-NOT NEW-UNADJUD, ONE AUTH NO. ONLY / MINING CLAIM MONEY RECEIVED (455) CASES: AMC203191/\$200.00	MAINT 2004 (2)	- n/a -	200.00
TOTAL:					\$200.00

PAYMENT INFORMATION			
1	AMOUNT:	\$200.00	POSTMARKED: N/A
	TYPE:	CASH	RECEIVED: 08/04/2003
	NAME:	JORDAN, ROBERT 6546 E ADOBE RD MESA AZ 85205	

REMARKS

This receipt was generated by the automated BLM Collections and Billing System and is a paper representation of a portion of the official electronic record contained therein.

057786
CK # 3540

MAINTENANCE FEE PAYMENT

\$100.00 MAINTENANCE FEE PAYMENT DUE ON OR BEFORE AUGUST 31, 2002
IN LIEU OF ASSESSMENT WORK FOR THE UPCOMING ASSESSMENT
YEAR BEGINNING SEPTEMBER 1 OF THE YEAR NOTED ABOVE

Bureau Of Land Management
Arizona State Office
222 North Central Avenue
Phoenix, AZ. 85004-2203

COUNT: 2 \$ 300.00 INT: MC
FOR OFFICIAL USE ONLY

THE CLAIMS ARE SITUATED IN YAVAPAI COUNTY,
ARIZONA.

BLM SERIAL NUMBERS NAMES OF CLAIMS OR SITES

A MC _____ THRU A MC _____
COUNTY BOOK/DOCKET _____, PAGE(S) OR FEE NO(S) _____

A MC _____ THRU A MC _____
COUNTY BOOK/DOCKET _____, PAGE(S) OR FEE NO(S) _____

(OR) IF NOT CONSECUTIVE NUMBERS LIST SEPARATELY BELOW:

BLM SERIAL NUMBERS	NAME OF CLAIMS/SITES	COUNTY BOOK/DOCKET & PAGE OR FEE NUMBER
A MC <u>203191</u>	<u>HONEY BE</u>	<u>2541/191</u>
A MC <u>262638</u>	<u>DJ-10</u>	<u>2713/239</u>
A MC _____	_____	_____
A MC _____	_____	_____
A MC _____	_____	_____
A MC _____	_____	_____
A MC _____	_____	_____
A MC _____	_____	_____
A MC _____	_____	_____
A MC _____	_____	_____

CLAIMANT'S NAME: ROBERT JORDAN

ADDRESS: 6546 EAST ADDE RD CITY: MESA STATE: AZ.

CHECK HERE IF THIS IS A CHANGE OF ADDRESS PHONE: 480 983-5550 ZIP: 85205

SIGNATURE: Robert Jordan
TO RECORD WITH THE COUNTY, ONE CLAIMANT OR THE AGENT MUST SIGN

LIST ALL ADDITIONAL OWNERS ON REVERSE SIDE OF THIS FORM

FOR OFFICIAL USE ONLY

RECEIVED
B.L.M. AZ STATE OFFICE
AUG 12 2002
ENTERED INTO COMPUTER
9/11/02TK

United States Department of the Interior
Bureau of Land Management
 BUSINESS & SUPPORT SVCS DIV
 222 N CENTRAL AVE
 PHOENIX, AZ 85004 -2203
 Phone: (602) 417-9200

Receipt	
No:	537786

Transaction #: 562238
Date of Transaction: 08/12/2002
CUSTOMER: ROBERT JORDAN 6546 E ADOBE RD MESA, AZ 85205

LINE #	QTY	DESCRIPTION	REMARKS	UNIT PRICE	TOTAL
1	1.00	LOCATABLE MINERALS / MINING CLAIMS-NOT NEW-UNADJUD, ONE AUTH NO. ONLY / MINING CLAIM MONEY RECEIVED (455) CASES: AMC203191/\$200.00	MAINT 2003 (2)	- n/a -	200.00
TOTAL:					\$200.00

PAYMENT INFORMATION			
1	AMOUNT:	\$200.00	POSTMARKED: N/A
	TYPE:	CHECK	RECEIVED: 08/12/2002
	CHECK NO:	3540	
	NAME:	JORDAN, ROBERT 6546 E ADOBE RD MESA AZ 85205	

REMARKS

This receipt was generated by the automated BLM Collections and Billing System and is a paper representation of a portion of the official electronic record contained therein.

MAINTENANCE FEE PAYMENT

\$100.00 MAINTENANCE FEE PAYMENT DUE ON OR BEFORE AUGUST 31, ~~200~~ ²⁰⁰¹
 IN LIEU OF ASSESSMENT WORK FOR THE UPCOMING ASSESSMENT
 YEAR BEGINNING SEPTEMBER 1 OF THE YEAR NOTED ABOVE.

Bureau Of Land Management
 Arizona State Office
 222 North Central Avenue
 Phoenix, AZ. 85004-2203

COUNT: 2 \$ 200.⁰⁰ INT: KC
 FOR OFFICIAL USE ONLY

THE CLAIMS ARE SITUATED IN YAVAPAI COUNTY, ARIZONA.

BLM SERIAL NUMBERS	NAMES OF CLAIMS OR SITES
A MC _____ THRU A MC _____	_____
COUNTY BOOK/DOCKET _____, PAGE(S) OR FEE NO(S) _____	_____
A MC _____ THRU A MC _____	_____
COUNTY BOOK/DOCKET _____, PAGE(S) OR FEE NO(S) _____	_____

(OR) IF NOT CONSECUTIVE NUMBERS LIST SEPARATELY BELOW:

BLM SERIAL NUMBERS	NAME OF CLAIMS/SITES	COUNTY BOOK/DOCKET & PAGE OR FEE NUMBER
A MC <u>203191</u>	<u>HONEY BEE</u>	<u>2541/191</u>
A MC <u>267638</u>	<u>DJ-10</u>	<u>2713/239</u>
A MC _____	_____	_____
A MC _____	_____	_____
A MC _____	_____	_____
A MC _____	_____	_____
A MC _____	_____	_____
A MC _____	_____	_____
A MC _____	_____	_____

RECEIVED
 BLM STATE OFFICE
 PHOENIX, ARIZONA
 2001 AUG -2 A 11:56

CLAIMANT'S NAME: ROBERT JORDAN
 ADDRESS: 6546 EAST ADDEE CITY: MESA STATE: AZ

CHECK HERE IF THIS IS A CHANGE OF ADDRESS PHONE: (480) 985-5350 ZIP: 83208

SIGNATURE: Robert Jordan
 TO RECORD WITH THE COUNTY, ONE CLAIMANT OR THE AGENT MUST SIGN

TIME STAMP

LIST ALL ADDITIONAL OWNERS ON REVERSE SIDE OF THIS FORM
 FOR OFFICIAL USE ONLY **ENTERED INTO COMPUTER**
 TK 10/4/01

United States Department of the Interior
Bureau of Land Management
 BUSINESS & SUPPORT SVCS DIV
 222 N CENTRAL AVE
 PHOENIX, AZ 85004 -2203
 Phone: (602) 417-9200

Receipt	
No:	348944

Transaction #: 367022
 Date of Transaction: 08/02/2001

CUSTOMER: ROBERT JORDAN
 6546 E. ADOBE
 MESA, AZ 85205

LINE #	QTY	COMMODITY / SUBJECT / ACTION / PRODUCT	REMARKS	UNIT PRICE	TOTAL
1	1.00	LOCATABLE MINERALS / MINING CLAIMS-NOT NEW-UNADJUD, ONE AUTH NO. ONLY / MINING CLAIM MONEY RECEIVED (455)	MAINT FEES 2002 (1) <i>ke</i> 2	- n/a -	\$200.00
TOTAL:					\$200.00

PAYMENT INFORMATION			
1	AMOUNT:	\$200.00	POSTMARKED: N/A
	TYPE:	CASH	RECEIVED: 08/02/2001
	NAME:	JORDAN, ROBERT 6546 E. ADOBE MESA AZ 85205	

REMARKS

CASE SERIAL NUMBER INFORMATION		
TRNS #	LINE #	CASES
367022	1	AMC203191/\$200.00

This receipt was generated by the automated BLM Collections and Billings System and is a paper representation of a portion of the official electronic record contained therein.

MAINTENANCE FEE PAYMENT

\$100.00 MAINTENANCE FEE PAYMENT DUE ON OR BEFORE AUGUST 31, 19 2000
 IN LIEU OF ASSESSMENT WORK FOR THE UPCOMING ASSESSMENT
 YEAR BEGINNING SEPTEMBER 1 OF THE YEAR NOTED ABOVE.

BUREAU OF LAND MANAGEMENT
 ARIZONA STATE OFFICE
 222 NORTH CENTRAL AVENUE
 PHOENIX, AZ 85004

COUNT: 2 \$ 200.00 INT: 100 FOR
OFFICIAL USE ONLY

THE CLAIMS ARE SITUATED IN YAVAPAI COUNTY, ARIZONA.

BLM SERIAL NUMBERS	NAMES OF CLAIMS OR SITES
A MC _____ THRU A MC _____ COUNTY BOOK/DOCKET _____, PAGE(S) OR FEE NO(S) _____	
A MC _____ THRU A MC _____ COUNTY BOOK/DOCKET _____, PAGE(S) OR FEE NO(S) _____	

(OR) IF NOT CONSECUTIVE NUMBERS LIST SEPARATELY BELOW:

BLM SERIAL NUMBERS	NAME OF CLAIMS/SITES	COUNTY BOOK/DOCKET & PAGE OR FEE NUMBER
A MC <u>203191</u>	<u>HONEY BEE</u>	<u>2541 / 191</u>
A MC <u>262638</u>	<u>DJ-10</u>	<u>2713 / 239</u>
A MC _____	_____	_____
A MC _____	_____	_____
A MC _____	_____	_____
A MC _____	_____	_____
A MC _____	_____	_____
A MC _____	_____	_____
A MC _____	_____	_____
A MC _____	_____	_____
A MC _____	_____	_____
A MC _____	_____	_____
A MC _____	_____	_____
A MC _____	_____	_____

CLAIMANT'S NAME: ROBERT JORDAN
 ADDRESS: 6546 E. ADOBE RD CITY: MESA STATE: AZ ZIP: 85205
 CHECK HERE IF THIS PHONE: 480 985-5550
 IS A CHANGE OF ADDRESS

SIGNATURE: Robert Jordan
 TO RECORD WITH THE COUNTY, ONE CLAIMANT OR THE AGENT MUST SIGN

LIST ALL ADDITIONAL OWNERS ON REVERSE SIDE OF THIS FORM

FOR OFFICIAL USE ONLY
 ENTERED INTO COMPUTER: 8/18/00 R So
 DATE INITIALS VERIFIED

TIME STAMP
 PHOENIX, ARIZONA
 2000 AUG - 8 P 12:38
 RECEIVED
 BLM STATE OFFICE

43 CFR 3833.0-5(e) (August 30, 1994) REQUIRES THAT THE NAMES OF ALL OF THE OWNERS AND THEIR CURRENT ADDRESSES SHALL BE IDENTIFIED ON ALL INSTRUMENTS REQUIRED TO BE RECORDED OR FILED BY THE REGULATIONS, 43 CFR SUBPART 3833.

CLAIMANT'S NAME: _____
ADDRESS: _____ CITY: _____ STATE: _____ ZIP: _____
 CHECK HERE IF THIS PHONE: () _____
IS A CHANGE OF ADDRESS

CLAIMANT'S NAME: _____
ADDRESS: _____ CITY: _____ STATE: _____ ZIP: _____
 CHECK HERE IF THIS PHONE: () _____
IS A CHANGE OF ADDRESS

CLAIMANT'S NAME: _____
ADDRESS: _____ CITY: _____ STATE: _____ ZIP: _____
 CHECK HERE IF THIS PHONE: () _____
IS A CHANGE OF ADDRESS

CLAIMANT'S NAME: _____
ADDRESS: _____ CITY: _____ STATE: _____ ZIP: _____
 CHECK HERE IF THIS PHONE: () _____
IS A CHANGE OF ADDRESS

CLAIMANT'S NAME: _____
ADDRESS: _____ CITY: _____ STATE: _____ ZIP: _____
 CHECK HERE IF THIS PHONE: () _____
IS A CHANGE OF ADDRESS

CLAIMANT'S NAME: _____
ADDRESS: _____ CITY: _____ STATE: _____ ZIP: _____
 CHECK HERE IF THIS PHONE: () _____
IS A CHANGE OF ADDRESS

CLAIMANT'S NAME: _____
ADDRESS: _____ CITY: _____ STATE: _____ ZIP: _____
 CHECK HERE IF THIS PHONE: () _____
IS A CHANGE OF ADDRESS

CLAIMANT'S NAME: _____
ADDRESS: _____ CITY: _____ STATE: _____ ZIP: _____
 CHECK HERE IF THIS PHONE: () _____
IS A CHANGE OF ADDRESS

United States Department of the Interior
Bureau of Land Management
 BUSINESS & SUPPORT SVCS DIV
 222 N CENTRAL AVE
 PHOENIX, AZ 85004 -2203
 Phone: (602) 417-9200

Receipt	
No:	164829

Transaction #: 177884
Date of Transaction: 08/08/2000

CUSTOMER: ROBERT JORDAN
 6546 E ADOBE RD
 MESA, AZ 85205

LINE #	QTY	COMMODITY / SUBJECT / ACTION / PRODUCT	REMARKS	UNIT PRICE	TOTAL
1	1	LOCATABLE MINERALS / MINING CLAIMS-ACCOUNTS/UNADJUDICATED / MINING CLAIM MONEY RECEIVED (455)	MAINT 2001 (2)	- n/a -	\$200.00
TOTAL:					\$200.00

PAYMENT INFORMATION			
1	AMOUNT:	\$200.00	POSTMARKED: N/A
	TYPE:	CASH	RECEIVED: 08/08/2000
	NAME:	JORDAN, ROBERT 6546 E ADOBE RD MESA AZ 85205	

REMARKS

CASE SERIAL NUMBER INFORMATION		
TRNS #	LINE #	CASES
177884	1	AMC203191

This receipt was generated by the automated BLM Collections and Billings System and is a paper representation of a portion of the official electronic record contained therein.

43 CFR 3833.0-5(e) (August 30, 1994) REQUIRES THAT THE NAMES OF ALL OF THE OWNERS AND THEIR CURRENT ADDRESSES SHALL BE IDENTIFIED ON ALL INSTRUMENTS REQUIRED TO BE RECORDED OR FILED BY THE REGULATIONS, 43 CFR SUBPART 3833.

CLAIMANT'S NAME: _____

ADDRESS: _____ CITY: _____ STATE: _____

CHECK HERE IF THIS IS CHANGE OF ADDRESS PHONE: (_____) _____ ZIP: _____

CLAIMANT'S NAME: _____

ADDRESS: _____ CITY: _____ STATE: _____

CHECK HERE IF THIS IS CHANGE OF ADDRESS PHONE: (_____) _____ ZIP: _____

CLAIMANT'S NAME: _____

ADDRESS: _____ CITY: _____ STATE: _____

CHECK HERE IF THIS IS CHANGE OF ADDRESS PHONE: (_____) _____ ZIP: _____

CLAIMANT'S NAME: _____

ADDRESS: _____ CITY: _____ STATE: _____

CHECK HERE IF THIS IS CHANGE OF ADDRESS PHONE: (_____) _____ ZIP: _____

CLAIMANT'S NAME: _____

ADDRESS: _____ CITY: _____ STATE: _____

CHECK HERE IF THIS IS CHANGE OF ADDRESS PHONE: (_____) _____ ZIP: _____

CLAIMANT'S NAME: _____

ADDRESS: _____ CITY: _____ STATE: _____

CHECK HERE IF THIS IS CHANGE OF ADDRESS PHONE: (_____) _____ ZIP: _____

CLAIMANT'S NAME: _____

ADDRESS: _____ CITY: _____ STATE: _____

CHECK HERE IF THIS IS CHANGE OF ADDRESS PHONE: (_____) _____ ZIP: _____

UNITED STATES
DEPARTMENT OF THE INTERIOR
BUREAU OF LAND MANAGEMENT

RECEIPT AND ACCOUNTING ADVICE CD/AZ NO. 2296567 ⁰⁷

CLAIM MAINTENANCE FEE 2000 1 6 13 200.00
2 CLAIMS

Subject:
Applicant: ROBERT JORDAN
6546 E ADOBE RD
MESA AZ 85205

CASH
Remitter: 480-985-5550

Assignor:

LEASE MANAGEMENT DATA										<input type="checkbox"/> NEW	<input type="checkbox"/> UPDATE	<input type="checkbox"/> PAYMENT
ORIGINAL SERIAL NO.	ASG.	TYPE	ST.	CTY.	FUND SYMBOL			ACRES/UNITS	RATE			

AMOUNT	ANV. DATE	EXP. DATE	BILL CYC.	S/C	DISTRICT	NEXT BILL	MISC. DATA	U of M	ACTUAL UNITS

ASSIGNMENT SERIAL NO.	ASG.	TYPE	ST.	CTY.	FUND SYMBOL			ACRES/UNITS	RATE	

AMOUNT	ANV. DATE	EXP. DATE	BILL CYC.	S/C	DISTRICT	NEXT BILL	MISC. DATA	U of M	ACTUAL UNITS

APPLY REMITTANCE			
ACTION	FUND SYMBOL	CTY.	AMOUNT
FILING FEE			
RENTAL			
UNEARNED			
REFUND			
TOTAL			
AMOUNT DUE			

Remarks:

BY: _____ DATE: _____

Lease in Escrow?
 KGS? Of Interest?
 Auto Escalates? Operating Rights?
 Auto Renew? Operator
 Bond Filed?

FOR MMS USE ONLY

BILLEE		FOREST REFUGE
NUMBER		
OCS SECTION		
CODE		

203191
262634-

MAINTENANCE FEE PAYMENT

\$100.00 MAINTENANCE FEE PAYMENT DUE ON OR BEFORE AUGUST 31, 1998
IN LIEU OF ASSESSMENT WORK FOR THE UPCOMING ASSESSMENT
YEAR BEGINNING SEPTEMBER 1 OF THE YEAR NOTED ABOVE.

BUREAU OF LAND MANAGEMENT
ARIZONA STATE OFFICE
222 NORTH CENTRAL AVENUE
PHOENIX, AZ 85004

COUNT: 2 \$ 200.00 INT: KC FOR
OFFICIAL USE ONLY

THE CLAIMS ARE SITUATED IN YAVAPAI COUNTY, ARIZONA.

BLM SERIAL NUMBERS

NAMES OF CLAIMS OR SITES

A MC _____ THRU A MC _____
COUNTY BOOK/DOCKET _____, PAGE(S) OR FEE NO(S) _____

A MC _____ THRU A MC _____
COUNTY BOOK/DOCKET _____, PAGE(S) OR FEE NO(S) _____

(OR) IF NOT CONSECUTIVE NUMBERS LIST SEPARATELY BELOW:

BLM SERIAL NUMBERS	NAME OF CLAIMS/SITES	COUNTY BOOK/DOCKET & PAGE OR FEE NUMBER
A MC <u>203191</u>	<u>HONEY BEE</u>	<u>2541/191</u>
A MC <u>262638</u>	<u>DJ-10</u>	<u>2713/239</u>
A MC _____	_____	_____
A MC _____	_____	_____
A MC _____	_____	_____
A MC _____	_____	_____
A MC _____	_____	_____
A MC _____	_____	_____
A MC _____	_____	_____
A MC _____	_____	_____
A MC _____	_____	_____
A MC _____	_____	_____

CLAIMANT'S NAME: ROBERT JORDAN

ADDRESS: 6546 E. ADOBE CITY: MESA STATE: AZ ZIP: 85205

CHECK HERE IF THIS IS A CHANGE OF ADDRESS PHONE: () _____

SIGNATURE: Robert Jordan
TO RECORD WITH THE COUNTY, ONE CLAIMANT OR THE AGENT MUST SIGN

LIST ALL ADDITIONAL OWNERS ON REVERSE SIDE OF THIS FORM
FOR OFFICIAL USE ONLY
ENTERED INTO COMPUTER: 8/18/98 [Signature] [Signature]
DATE INITIALS VERIFIED

TIME STAMP
PHOENIX, ARIZONA
1998 AUG 17 A 10:43
RECEIVED
BLM, AZ STATE OFFICE

43 CFR 3833.0-5(e) (August 30, 1994) REQUIRES THAT THE NAMES OF ALL OF THE OWNERS AND THEIR CURRENT ADDRESSES SHALL BE IDENTIFIED ON ALL INSTRUMENTS REQUIRED TO BE RECORDED OR FILED BY THE REGULATIONS, 43 CFR SUBPART 3833.

CLAIMANT'S NAME: _____
ADDRESS: _____ CITY: _____ STATE: _____ ZIP: _____
 CHECK HERE IF THIS PHONE: () _____
IS A CHANGE OF ADDRESS

CLAIMANT'S NAME: _____
ADDRESS: _____ CITY: _____ STATE: _____ ZIP: _____
 CHECK HERE IF THIS PHONE: () _____
IS A CHANGE OF ADDRESS

CLAIMANT'S NAME: _____
ADDRESS: _____ CITY: _____ STATE: _____ ZIP: _____
 CHECK HERE IF THIS PHONE: () _____
IS A CHANGE OF ADDRESS

CLAIMANT'S NAME: _____
ADDRESS: _____ CITY: _____ STATE: _____ ZIP: _____
 CHECK HERE IF THIS PHONE: () _____
IS A CHANGE OF ADDRESS

CLAIMANT'S NAME: _____
ADDRESS: _____ CITY: _____ STATE: _____ ZIP: _____
 CHECK HERE IF THIS PHONE: () _____
IS A CHANGE OF ADDRESS

CLAIMANT'S NAME: _____
ADDRESS: _____ CITY: _____ STATE: _____ ZIP: _____
 CHECK HERE IF THIS PHONE: () _____
IS A CHANGE OF ADDRESS

CLAIMANT'S NAME: _____
ADDRESS: _____ CITY: _____ STATE: _____ ZIP: _____
 CHECK HERE IF THIS PHONE: () _____
IS A CHANGE OF ADDRESS

CLAIMANT'S NAME: _____
ADDRESS: _____ CITY: _____ STATE: _____ ZIP: _____
 CHECK HERE IF THIS PHONE: () _____
IS A CHANGE OF ADDRESS

UNITED STATES
DEPARTMENT OF THE INTERIOR
BUREAU OF LAND MANAGEMENT

RECEIPT AND ACCOUNTING ADVICE

NO. 2389364 04

TC/AZ 08/17/98

Subject: CLAIM MAINTENANCE FEE 1999 - 2 2 5 13 200.00

Applicant:
ROBERT JORDAN
6546 E ADOBE
MESA AZ 85205

Remitter: CK 2208
602 985-5550

Assignor:

LEASE MANAGEMENT DATA NEW UPDATE PAYMENT

ORIGINAL SERIAL NO.	ASG.	TYPE	ST.	CTY.	FUND SYMBOL	ACRES/UNITS	RATE
AMC 203191, ET AL							

AMOUNT	ANV. DATE	EXP. DATE	BILL CYC.	S/C	DISTRICT	NEXT BILL	MISC. DATA	U of M	ACTUAL UNITS

ASSIGNMENT SERIAL NO.	ASG.	TYPE	ST.	CTY.	FUND SYMBOL	ACRES/UNITS	RATE

AMOUNT	ANV. DATE	EXP. DATE	BILL CYC.	S/C	DISTRICT	NEXT BILL	MISC. DATA	U of M	ACTUAL UNITS

APPLY REMITTANCE

ACTION	FUND SYMBOL	CTY.	AMOUNT
FILING FEE			
RENTAL			
UNEARNED			
REFUND			
TOTAL			
AMOUNT DUE			

Remarks:

BY: _____ DATE: _____

Lease in Escrow?
 KGS? Of Interest?
 Auto Escalates? Operating Rights?
 Auto Renew? Operator
 Bond Filed?

FOR MMS USE ONLY

BILLEE	FOREST REFUGE
NUMBER	
OCS SECTION	
CODE	

MAINTENANCE FEE PAYMENT

\$100.00 MAINTENANCE FEE PAYMENT DUE ON OR BEFORE AUGUST 31, 1996
IN LIEU OF ASSESSMENT WORK FOR THE UPCOMING ASSESSMENT
YEAR BEGINNING SEPTEMBER 1 OF THE YEAR NOTED ABOVE.

BUREAU OF LAND MANAGEMENT
ARIZONA STATE OFFICE
3707 NORTH 7TH STREET
PHOENIX, AZ 85014 (OR)
P.O. BOX 16563, PHOENIX, AZ 85011

262634
COUNT: 2 \$ 200.00 INT: KC
FOR OFFICIAL USE ONLY

THE CLAIMS ARE SITUATED IN YAVAPAI COUNTY,
ARIZONA.

BLM SERIAL NUMBERS NAMES OF CLAIMS OR SITES
A MC _____ THRU A MC _____
COUNTY BOOK/DOCKET _____, PAGE(S) OR FEE NO(S) _____
A MC _____ THRU A MC _____
COUNTY BOOK/DOCKET _____, PAGE(S) OR FEE NO(S) _____

(OR) IF NOT CONSECUTIVE NUMBERS LIST SEPARATELY BELOW:

BLM SERIAL NUMBERS	NAME OF CLAIMS/SITES	COUNTY BOOK/DOCKET & PAGE OR FEE NUMBER
A MC <u>203191</u>	<u>HONEY BEE</u>	
A MC <u>262639</u>	<u>DJ-10</u>	
A MC _____	_____	_____
A MC _____	_____	_____
A MC _____	_____	_____
A MC _____	_____	_____
A MC _____	_____	_____
A MC _____	_____	_____
A MC _____	_____	_____

CLAIMANT'S NAME: ROBERT JORDAN

ADDRESS: 6546 E. ADOBE RD. CITY: MESA STATE: AZ

CHECK HERE IF THIS IS A CHANGE OF ADDRESS. PHONE: (602) 985-5550 ZIP: 85205

SIGNATURE: Robert Jordan
TO RECORD WITH THE COUNTY, ONE CLAIMANT OR THE AGENT MUST SIGN

LIST ALL ADDITIONAL OWNERS ON REVERSE SIDE OF THIS FORM

FOR OFFICIAL USE ONLY
ENTERED INTO COMPUTER: _____ DATE: SEP 05 1995 INITIALS: JB VERIFIED: ERS

TIME STAMP
RECEIVED
BLM AZ STATE OFFICE
Aug 13 5 50 AM '96
PHOENIX, ARIZONA

MAINTENANCE FEE PAYMENT

**\$100.00 MAINTENANCE FEE PAYMENT DUE ON OR BEFORE AUGUST 31, 19 95
IN LIEU OF ASSESSMENT WORK FOR THE UPCOMING ASSESSMENT
YEAR BEGINNING SEPTEMBER 1 OF THE YEAR NOTED ABOVE.**

BUREAU OF LAND MANAGEMENT
ARIZONA STATE OFFICE
3707 NORTH 7TH STREET
PHOENIX, AZ 85014 (OR)
P.O. BOX 16563, PHOENIX, AZ 85011

AMC 203191

COUNT: 1 \$ 100.00 INT: DLL
FOR OFFICIAL USE ONLY

THE CLAIMS ARE SITUATED IN YAVAPAI COUNTY, ARIZONA.

BLM SERIAL NUMBERS **NAMES OF CLAIMS OR SITES**

A MC _____ THRU A MC _____

COUNTY BOOK/DOCKET _____, PAGE(S) OR FEE NO(S) _____

A MC _____ THRU A MC _____

COUNTY BOOK/DOCKET _____, PAGE(S) OR FEE NO(S) _____

(OR) IF NOT CONSECUTIVE NUMBERS LIST SEPARATELY BELOW:

BLM SERIAL NUMBERS	NAME OF CLAIMS/SITES	COUNTY BOOK/DOCKET & PAGE OR FEE NUMBER
A MC <u>203191</u>	<u>HONEY BEE</u>	_____
A MC _____	_____	_____
A MC _____	_____	_____
A MC _____	_____	_____
A MC _____	_____	_____
A MC _____	_____	_____
A MC _____	_____	_____
A MC _____	_____	_____
A MC _____	_____	_____
A MC _____	_____	_____

CLAIMANT'S NAME: ROBERT JORDAN

ADDRESS: 6546 E. ADOBE RD. CITY: MESA STATE: AZ

CHECK HERE IF THIS IS A CHANGE OF ADDRESS PHONE: (602) 985-5550 ZIP: 85205

SIGNATURE: Robert Jordan *not an owner 8/17/95 Spinos*
TO RECORD WITH THE COUNTY, ONE CLAIMANT OR THE AGENT MUST SIGN

TIME STAMP

LIST ALL ADDITIONAL OWNERS ON REVERSE SIDE OF THIS FORM

FOR OFFICIAL USE ONLY

ENTERED INTO COMPUTER: 8/17/95 DATE Spinos INITIALS SP VERIFIED

RECEIVED
BLM AZ STATE OFFICE
AUG 10 07 AM '95

43 CFR 3833.0-5(e) (August 30, 1994) REQUIRES THAT THE NAMES OF ALL OF THE OWNERS AND THEIR CURRENT ADDRESSES SHALL BE IDENTIFIED ON ALL INSTRUMENTS REQUIRED TO BE RECORDED OR FILED BY THE REGULATIONS, 43 CFR SUBPART 3833.

CLAIMANT'S NAME: _____

ADDRESS: _____ CITY: _____ STATE: _____

CHECK HERE IF THIS IS CHANGE OF ADDRESS PHONE: () _____ ZIP: _____

CLAIMANT'S NAME: _____

ADDRESS: _____ CITY: _____ STATE: _____

CHECK HERE IF THIS IS CHANGE OF ADDRESS PHONE: () _____ ZIP: _____

CLAIMANT'S NAME: _____

ADDRESS: _____ CITY: _____ STATE: _____

CHECK HERE IF THIS IS CHANGE OF ADDRESS PHONE: () _____ ZIP: _____

CLAIMANT'S NAME: _____

ADDRESS: _____ CITY: _____ STATE: _____

CHECK HERE IF THIS IS CHANGE OF ADDRESS PHONE: () _____ ZIP: _____

CLAIMANT'S NAME: _____

ADDRESS: _____ CITY: _____ STATE: _____

CHECK HERE IF THIS IS CHANGE OF ADDRESS PHONE: () _____ ZIP: _____

CLAIMANT'S NAME: _____

ADDRESS: _____ CITY: _____ STATE: _____

CHECK HERE IF THIS IS CHANGE OF ADDRESS PHONE: () _____ ZIP: _____

CLAIMANT'S NAME: _____

ADDRESS: _____ CITY: _____ STATE: _____

CHECK HERE IF THIS IS CHANGE OF ADDRESS PHONE: () _____ ZIP: _____

UNITED STATES
DEPARTMENT OF THE INTERIOR
BUREAU OF LAND MANAGEMENT

RECEIPT AND ACCOUNTING ADVICE

NO. **2147417** 04

WG/AZ

08/08/95

Subject: CLAIM MAINTENANCE FEE 1996 (2)

1 6 13

200.00

Applicant:

ROBERT JORDAN
6546 E. ADOBE RD.
MESA AZ. 85205

Remitter: SAME CASH
602-985-5550

Assignor:

LEASE MANAGEMENT DATA									
<input type="checkbox"/> NEW <input type="checkbox"/> UPDATE <input type="checkbox"/> PAYMENT									
ORIGINAL SERIAL NO.	ASG.	TYPE	ST.	CTY.	FUND SYMBOL			ACRES/UNITS	RATE
AMC 203191, ET AL									
AMOUNT	ANV. DATE	EXP. DATE	BILL CYC.	S/C	DISTRICT	NEXT BILL	MISC. DATA	U of M	ACTUAL UNITS
ASSIGNMENT SERIAL NO.	ASG.	TYPE	ST.	CTY.	FUND SYMBOL			ACRES/UNITS	RATE
AMOUNT	ANV. DATE	EXP. DATE	BILL CYC.	S/C	DISTRICT	NEXT BILL	MISC. DATA	U of M	ACTUAL UNITS

APPLY REMITTANCE				Remarks: <i>Amc 262638</i> <i>Amc 203191</i> <i>SR</i>
ACTION	FUND SYMBOL	CTY.	AMOUNT	
FILING FEE				
RENTAL				
UNEARNED				
REFUND				
TOTAL				
AMOUNT DUE				

<input type="checkbox"/> Lease in Escrow? <input type="checkbox"/> KGS? <input type="checkbox"/> Auto Escalates? <input type="checkbox"/> Auto Renew?	Of Interest? Operating Rights? Operator Bond Filed?	FOR MMS USE ONLY	
		BILLEE NUMBER	FOREST REFUGE
		OCS SECTION CODE	

**\$100.00 MAINTENANCE FEE PAYMENT
FOR 1995 IN LIEU OF ASSESSMENT
DUE ON OR BEFORE AUGUST 31, 1994**

BUREAU OF LAND MANAGEMENT
ARIZONA STATE OFFICE
3707 N. 7TH STREET
PHOENIX, ARIZONA 85014 (OR)
P. O. BOX 16563, ZIP CODE 85011

AMC 203191

[Signature]

COUNT: 1 \$ 100⁰⁰
FOR OFFICIAL USE ONLY

B L M SERIAL NUMBERS	NAMES OF CLAIMS/SITES
A MC _____ THRU A MC _____	_____
A MC _____ THRU A MC _____	_____
A MC _____ THRU A MC _____	_____

(OR) IF NOT CONSECUTIVE NUMBERS, LIST SEPARATELY BELOW:

B L M SERIAL NUMBERS	NAMES OF CLAIMS/SITES
A MC <u>203191</u>	<u>HONEY BEE</u>
A MC _____	_____
A MC _____	_____
A MC _____	_____
A MC _____	_____
A MC _____	_____
A MC _____	_____
A MC _____	_____
A MC _____	_____
A MC _____	_____
A MC _____	_____
A MC _____	_____
A MC _____	_____

CLAIMANT'S NAME: ROBERT JORDAN

ADDRESS: 6262 E. BROWN RD #42

CITY: ME SA STATE: AZ.

PHONE: (602) 985-5550 ZIP: 85205

TIME
STAMP

RECEIVED
B.L.M. AZ STATE OFFICE
PHOENIX, ARIZONA
Aug 24 3 14 PM '94

CHECK HERE IF THIS IS A CHANGE OF ADDRESS. *name + address not changed*

FOR OFFICIAL USE ONLY			
ENTERED INTO COMPUTER: <u>9-9-94</u>	<i>[Signature]</i>	<u>9-12-94</u>	<u>E. Stahl</u>
DATE	INITIALS	VERIFIED	

Computer has no name of arrival state.

UNITED STATES
DEPARTMENT OF THE INTERIOR
BUREAU OF LAND MANAGEMENT

RECEIPT AND ACCOUNTING ADVICE

NO. 2024534 04

WG/AZ

08/24/94

OK

100.00

1 41 13

Subject: CLAIM MAINTENANCE FEE 1995 (1)

Applicant:

ROBERT JORDAN
6262 E. BROWN RD. # 42
MESA AZ. 85205

Remitter: SAME CASH
985-5550

Assignor:

LEASE MANAGEMENT DATA									
<input type="checkbox"/> NEW <input type="checkbox"/> UPDATE <input type="checkbox"/> PAYMENT									
ORIGINAL SERIAL NO.	ASG.	TYPE	ST.	CTY.	FUND SYMBOL			ACRES/UNITS	RATE
AMC 203191									
AMOUNT	ANV. DATE	EXP. DATE	BILL CYC.	S/C	DISTRICT	NEXT BILL	MISC. DATA	U of M	ACTUAL UNITS
ASSIGNMENT SERIAL NO.	ASG.	TYPE	ST.	CTY.	FUND SYMBOL			ACRES/UNITS	RATE
AMOUNT	ANV. DATE	EXP. DATE	BILL CYC.	S/C	DISTRICT	NEXT BILL	MISC. DATA	U of M	ACTUAL UNITS

APPLY REMITTANCE			
ACTION	FUND SYMBOL	CTY.	AMOUNT
FILING FEE			
RENTAL			
UNEARNED			
REFUND			
TOTAL			
AMOUNT DUE			

Remarks:
Amc 203191

BY: _____ DATE: _____

Lease in Escrow?
 KGS?
 Auto Escalates?
 Auto Renew?

Of Interest?
 Operating Rights?
 Operator
 Bond Filed?

FOR MMS USE ONLY

BILLEE NUMBER	FOREST REFUGE
OCS SECTION CODE	

203191

SR

Bureau of Land Management
Arizona State Office
3707 North 7th Street
Phoenix, Arizona 85014

ROBERT JORDAN
6262 E. BROWN RD #42
MESA, AZ. 85205

AMC # 203191 ✓

HONEY BEE

I AM FILING FOR 1993 AND 1994

Robert Jordan

ENTERED IN COMPUTER

SEP 24 1993 - *Skinner*

ck- MXT

RECEIVED
BLM, AZ STATE OFFICE
PHOENIX, ARIZONA
AUG 26 2 32 PM '93

UNITED STATES
DEPARTMENT OF THE INTERIOR
BUREAU OF LAND MANAGEMENT

RECEIPT AND ACCOUNTING ADVICE

NO. 2044702 04

RS/AZ 08/26/93

Subject: CLAIM RENTAL FEE 1993 & 1994 (1)

1 109 13 200.00

Applicant:
ROBERT JORDAN
6262 E. BROWN RD., #42
MESA, AZ 85205

Remitter: SAME - CASH

Assignor:

LEASE MANAGEMENT DATA NEW UPDATE PAYMENT

ORIGINAL SERIAL NO.	ASG.	TYPE	ST.	CTY.	FUND SYMBOL	ACRES/UNITS	RATE
AMC 203191							

AMOUNT	ANV. DATE	EXP. DATE	BILL CYC.	S/C	DISTRICT	NEXT BILL	MISC. DATA	U of M	ACTUAL UNITS

ASSIGNMENT SERIAL NO.	ASG.	TYPE	ST.	CTY.	FUND SYMBOL	ACRES/UNITS	RATE

AMOUNT	ANV. DATE	EXP. DATE	BILL CYC.	S/C	DISTRICT	NEXT BILL	MISC. DATA	U of M	ACTUAL UNITS

APPLY REMITTANCE

ACTION	FUND SYMBOL	CTY.	AMOUNT
FILING FEE			
RENTAL			
UNEARNED			
REFUND			
TOTAL			
AMOUNT DUE			

Remarks:

BY: _____ DATE: _____

- Lease in Escrow?
- KGS? Of Interest?
- Auto Escalates? Operating Rights?
- Auto Renew? Operator
- Bond Filed?

FOR MMS USE ONLY	
BILLEE NUMBER	FOREST REFUGE
OCS SECTION CODE	

STATE OF ARIZONA, } ss. I hereby certify that the within instrument was filed and recorded | Fee No.:

County of _____
In Docket No. _____ INDEXED & MICROFILMED Page _____

RECORDED YAVAPAI COUNTY ARIZONA

INSTRUMENT # 9234447
OFFICIAL RECORDS OF
YAVAPAI COUNTY
PATSY C. JENNEY
REQUEST OF:

ARVIN STOTT
DATE: 08/14/92 TIME: 13:15
FEE: 5.00 SC: 4.00 PT: 1.00
BOOK 2520 PAGE 024 PAGES: 001

BR	5
WAP	34
PCL	31
315	

When recorded mail to:
Arvin Stott
P.O. Box 839
Black Canyon City AZ. 85324

AFFIDAVIT OF PERFORMANCE OF ANNUAL WORK

State of Arizona }
County of Yavapai } ss

1. Arvin Stott
Name
Box 839
Address
Black Canyon Arizona 85324
City State Zip

being duly sworn according to law deposes and says that they are a citizen of the United States more than eighteen years of age and that all of the facts set forth in this affidavit are true and correct according to the best of their knowledge, information and belief.

2. That they are personally acquainted with the mining claim named Honey Bee Ame 203191 situate in the Black Canyon Mining District, Yavapai County, Arizona, the location of which is recorded in the office of the County Recorder of that County in Book 1560, Page 142. Notice of location is posted in Section 32, Township 9 1/2, Range 2-E, G&SRB&M.

3. That between the dates of Sept. 1991 and Sept. 14-1992 at least Two Hundred Dollars (\$200.00) dollars worth of work and improvements were done and performed upon this claim not including location work.

4. The work and improvements were made by and at the expense of Arvin Stott, owners of the mine for the purpose of complying with the laws of the United States pertaining to assessments or annual work.

5. Lynn Stott + Arvin Stott were the names of the persons employed by the owner who labored to do the work and improvements.

6. The work and improvements done were Excavation - mining + road work

RECEIVED
BLM AZ STATE OFFICE
SEP 22 10 36 AM '92
PHOENIX, ARIZONA

Dated 8-14-92 Arvin Stott
Signature

Subscribed to and sworn before me, a Notary Public, this 14th day of August, 1992, by ARVIN STOTT

My Commission Kathleen V. Thurman
OFFICIAL SEAL
KATHLEEN V. THURMAN
NOTARY PUBLIC - STATE OF ARIZONA
YAVAPAI COUNTY
Notary Public

UNITED STATES
DEPARTMENT OF THE INTERIOR
BUREAU OF LAND MANAGEMENT

RECEIPT AND ACCOUNTING ADVICE

NO. 1925678²⁴

CP/AZ 09/22/92

Subject: AFFIDAVITS OF ASSESSMENT WORK (1) 1 10 12 5.00

Applicant:
ARVIN SCOTT
BOX 839
BLACK CANYON, AZ 85324

OK en

SAME - CASH

Remitter:

Assignor:

LEASE MANAGEMENT DATA										
<input type="checkbox"/> NEW <input type="checkbox"/> UPDATE <input type="checkbox"/> PAYMENT										
ORIGINAL SERIAL NO.	ASG.	TYPE	ST.	CTY.	FUND SYMBOL			ACRES/UNITS	RATE	
AMC 203191										
AMOUNT	ANV. DATE	EXP. DATE	BILL CYC.	S/C	DISTRICT	NEXT BILL	MISC. DATA	U of M	ACTUAL UNITS	
ASSIGNMENT SERIAL NO.	ASG.	TYPE	ST.	CTY.	FUND SYMBOL			ACRES/UNITS	RATE	
AMOUNT	ANV. DATE	EXP. DATE	BILL CYC.	S/C	DISTRICT	NEXT BILL	MISC. DATA	U of M	ACTUAL UNITS	

APPLY REMITTANCE			
ACTION	FUND SYMBOL	CTY.	AMOUNT
FILING FEE			
RENTAL			
UNEARNED			
REFUND			
TOTAL			
AMOUNT DUE			

Remarks:

ACK. CP

BY: _____ DATE: _____

Lease in Escrow?
 KGS?
 Auto Escalates?
 Auto Renew?

Of Interest?
 Operating Rights?
 Operator
 Bond Filed?

FOR MMS USE ONLY

BILLEE	FOREST REFUGE
NUMBER	
OCS SECTION	
CODE	

203191

STATE OF ARIZONA,

I hereby certify that the within instrument was filed and recorded | Fee No.:

County of _____

In Docket No. _____

Page _____

RUSH

When recorded _____

INDEXED & MICROFILMED

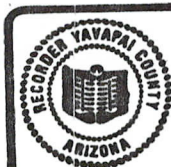

INSTRUMENT # 9131285
OFFICIAL RECORDS OF
YAVAPAI COUNTY
PATSY C. JENNEY
REQUEST OF:

ARVIN STOTT
DATE: 08/23/91 TIME: 09:35
FEE: 5.00 SC: 4.00 PT: 1.00
BOOK 2390 PAGE 379 PAGES: 001

BK	FEE
\$	\$
MAP	\$4
PCL	\$5
\$1	\$1
\$15	

AFFIDAVIT OF PERFORMANCE OF ANNUAL WORK

State of Arizona

County of Yavapai

ss

AMC 203191 ✓

1. ARVIN Stott

Name

P.O. Box 839

Address

Black Canyon City AZ 85324

City

State

Zip

being duly sworn according to law deposes and says that they are a citizen of the United States more than eighteen years of age and that all of the facts set forth in this affidavit are true and correct according to the best of their knowledge, information and belief.

2. That they are personally acquainted with the mining claim named Honey Bee situate in the Black Canyon Mining District,

Yavapai County, Arizona, the location of which is recorded in the office of the County Recorder of that County in Book 1560, Page 142. Notice of location is posted in Section 32, Township 9 1/2 N, Range 2-E, G&SRB&M.

3. That between the dates of Sept. 1, 1990 and Aug 23, 1991 at least \$200.00 - two Hundred dollars (\$200.00) dollars worth of work and improvements were done and performed upon this claim not including location work.

4. The work and improvements were made by and at the expense of Arvin Stott, owners of the mine for the purpose of complying with the laws of the United States pertaining to assessments or annual work.

5. Arvin Stott - Barbara Stott - Lynn Stott

were the names of the persons employed by the owner who labored to do the work and improvements.

6. The work and improvements done were mining + removal of over burden + waste material.

Dated 9-23-1991

Arvin Stott
Signature

RECEIVED
BLM AZ STATE OFFICE
PHOENIX, ARIZONA
Aug 30 1 03 PM '91

Subscribed to and sworn before me, a Notary Public, this 23rd day of August, 19 91, by ARVIN STOTT

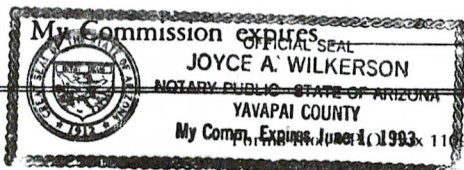

Joyce A. Wilkerson
Notary Public

UNITED STATES
DEPARTMENT OF THE INTERIOR
BUREAU OF LAND MANAGEMENT

RECEIPT AND ACCOUNTING ADVICE

NO. 1666442 04

SM/AZ 08/30/91

Subject: AFFIDAVITS OF ASSESSMENT WORK (1) 1 5 12 5.00

Applicant:
ARVIN STOTT
P. O. BOX 839
BLACK CANYON CITY, AZ 85324
Rmitter: SAME - CASH

Assignor:

LEASE MANAGEMENT DATA NEW UPDATE PAYMENT

ORIGINAL SERIAL NO.	ASG.	TYPE	ST.	CTY.	FUND SYMBOL	ACRES/UNITS	RATE
AMC 203191							

AMOUNT	ANV. DATE	EXP. DATE	BILL CYC.	S/C	DISTRICT	NEXT BILL	MISC. DATA	U of M	ACTUAL UNITS

ASSIGNMENT SERIAL NO.	ASG.	TYPE	ST.	CTY.	FUND SYMBOL	ACRES/UNITS	RATE

AMOUNT	ANV. DATE	EXP. DATE	BILL CYC.	S/C	DISTRICT	NEXT BILL	MISC. DATA	U of M	ACTUAL UNITS

APPLY REMITTANCE

ACTION	FUND SYMBOL	CTY.	AMOUNT
FILING FEE			
RENTAL			
UNEARNED			
REFUND			
TOTAL			
AMOUNT DUE			

Remarks:

ack. sgm
BY: _____ DATE: _____

Lease in Escrow?
 KGS? Of Interest?
 Auto Escalates? Operating Rights?
 Auto Renew? Operator
Bond Filed?

FOR MMS USE ONLY
BILLEE NUMBER
OCS SECTION CODE
FOREST REFUGE

STATE OF ARIZONA,

I, hereby certify that the within instrument was filed and recorded

Fee No.:

County of _____

RUSH

19 _____ at _____ M _____

In Docket No. _____



INSTRUMENT # 9033076
OFFICIAL RECORDS OF
YAVAPAI COUNTY
PATSY C. JENNEY
REQUEST OF:

ARVIN STOTT
DATE: 08/28/90 TIME: 10:55
FEE: 5.00 SC: 4.00 PT: 1.00
BOOK 2282 PAGE 960 PAGES: 001

LR	FEE
AP	01
FL	02
SI	03
5	15

When recorded mail to:

INDEXED & MICROFILMED

AFFIDAVIT OF PERFORMANCE OF ANNUAL WORK

State of Arizona

County of YAVAPAI

ss

203191
gip

1. Arvin Stott

Name

P.O. Box 839

Address

Black Canyon City

Arizona

85324

City

State

Zip

being duly sworn according to law deposes and says that they are a citizen of the United States more than eighteen years of age and that all of the facts set forth in this affidavit are true and correct according to the best of their knowledge, information and belief.

2. That they are personally acquainted with the mining claim named Honey Bee

A.M.C. 203191

situate in the Black Canyon Mining District,

Yavapai County, Arizona, the location of which is recorded in the office of the County Recorder of that County in Book 1560, Page 142. Notice of location is posted in Section 32, Township 9 1/2, Range 2-E, G&SRB&M.

3. That between the dates of Sept. 1989 and Aug. 30, 1990

at least Two Hundred Dollars (\$200.00) dollars worth of work and improvements were done and performed upon this claim not including location work.

4. The work and improvements were made by and at the expense of Arvin Stott

owners of the mine for the purpose of complying with the laws of the United States pertaining to assessments or annual work.

5. Walter (Red) McDonald + Arvin Stott

were the names of the persons employed by the owner who labored to do the work and improvements.

6. The work and improvements done were Excavation - mining + Removal of over burden

Dated 8-28-90

Arvin Stott
Signature

RECEIVED
BLM AT STATE OFFICE
DEC 21 12 26 PM 1990
PHOENIX, ARIZONA

Subscribed to and sworn before me, a Notary Public, this 28th day of August

1990, by Arvin Stott

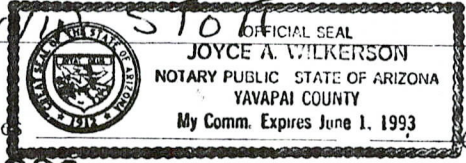

My Commission expires _____

Joyce A. Wilkerson
Notary Public

BOOK 2282 PAGE 960

UNITED STATES
DEPARTMENT OF THE INTERIOR
BUREAU OF LAND MANAGEMENT

RECEIPT AND ACCOUNTING ADVICE

NO. 1663847 04

WJ/AZ

12/21/90

OK

Subject: AFFIDAVITS OF ASSESSMENT WORK (1)

1 21 12

5.00

Applicant: ARVIN STOTT
P.O. BOX 839
BLACK CANYON CITY, AZ 85324

Remitter: CASH

Assignor:

LEASE MANAGEMENT DATA									
<input type="checkbox"/> NEW <input type="checkbox"/> UPDATE <input type="checkbox"/> PAYMENT									
ORIGINAL SERIAL NO.	ASG.	TYPE	ST.	CTY.	FUND SYMBOL			ACRES/UNITS	RATE
AMC 203191									
AMOUNT	ANV. DATE	EXP. DATE	BILL CYC.	S/C	DISTRICT	NEXT BILL	MISC. DATA	U of M	ACTUAL UNITS
ASSIGNMENT SERIAL NO.	ASG.	TYPE	ST.	CTY.	FUND SYMBOL			ACRES/UNITS	RATE
AMOUNT	ANV. DATE	EXP. DATE	BILL CYC.	S/C	DISTRICT	NEXT BILL	MISC. DATA	U of M	ACTUAL UNITS

APPLY REMITTANCE			
ACTION	FUND SYMBOL	CTY.	AMOUNT
FILING FEE			
RENTAL			
UNEARNED			
REFUND			
TOTAL			
AMOUNT DUE			

Remarks:

ack w/d

BY: _____ DATE: _____

- Lease in Escrow?
- KGS? Of Interest?
- Auto Escalates? Operating Rights?
- Auto Renew? Operator
- Bond Filed?

FOR MMS USE ONLY	
BILLEE	FOREST REFUGE
NUMBER	
OCS SECTION	
CODE	

STATE OF ARIZONA, } I hereby certify that the within instrument was filed and recorded | Fee No.:

County of _____ } ss. _____

In Docket No. _____, Page _____

When recorded mail to:

RECORDED YAVAPAI COUNTY ARIZONA

INSTRUMENT # 8930827
OFFICIAL RECORDS OF
YAVAPAI COUNTY
PATSY C. JENNEY
REQUEST OF:
ARVIN STOTT
DATE: 08/22/89 TIME: 15:00
FEE: 5.00
BOOK 2176 PAGE 106 PAGES: 001

INDEXED & MICROFILMED

AFFIDAVIT OF PERFORMANCE OF ANNUAL WORK

State of Arizona }
County of Yavapai } ss.

\$ 5	1	P 4	Co 5	5	St
Bk		Map			Pcl

M.A. # 10
ARVIN Stott
Name

P.O. Box 839
Address
Black Canyon City Az. 85324
City State Zip

being duly sworn according to law deposes and says that they are a citizen of the United States more than eighteen years of age and that all of the facts set forth in this affidavit are true and correct according to the best of their knowledge, information and belief.

- That they are personally acquainted with the mining claim named Honeybee AMC 203 191 situate in the Black Canyon Mining District, Yavapai County, Arizona, the location of which is recorded in the office of the County Recorder of that County in Book 1560, Page 142. Notice of location is posted in Section 32, Township 9 1/2 N, Range 2-E, G&SRB&M.
- That between the dates of Sept. 1 - 1988 and Aug 20 1989 at least \$100.00 one Hundred Dollars (\$ 100.00) dollars worth of work and improvements were done and performed upon this claim not including location work.
- The work and improvements were made by and at the expense of Arvin Stott, owners of the mine for the purpose of complying with the laws of the United States pertaining to assessments or annual work.
- Arvin Stott + Jon D. mcRee were the names of the persons employed by the owner who labored to do the work and improvements.
- The work and improvements done were Road work + mining

Dated 8-22-89

Arvin Stott
Signature

RECEIVED
B.L.M. AZ STATE OFFICE
CASH CHECK BY MO
REC'D
DEC 22 5 01 AM 1989
CLAIMS/SITE
THIS IS YOUR RECEIPT
AND ACKNOWLEDGMENT
OF
PAGE

Subscribed to and sworn before me, a Notary Public, this 22nd day of August, 1989, by Arvin Stott

My Commission

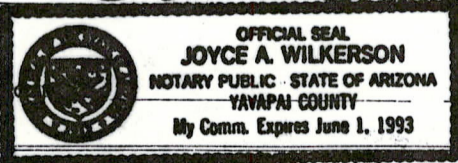

Joyce A. Wilkerson
Notary Public

UNITED STATES
DEPARTMENT OF THE INTERIOR
BUREAU OF LAND MANAGEMENT

RECEIPT AND ACCOUNTING ADVICE

NO. 1693399 *sk*

PROOF OF LABOR (1)

SGM/AZ 12-22-89 1 12

5.00
02

Subject:

ARVIN STOTT
P O BOX 839
BLACK CANYON CITY, AZ 85324

Applicant:

CASH

Remitter:

Assignor:

LEASE MANAGEMENT DATA NEW UPDATE PAYMENT

ORIGINAL SERIAL NO.	ASG.	TYPE	ST.	CTY.	FUND SYMBOL	ACRES/UNITS	RATE
AMC 203191							

AMOUNT	ANV. DATE	EXP. DATE	BILL CYC.	S/C	DISTRICT	NEXT BILL	MISC. DATA	U of M	ACTUAL UNITS

ASSIGNMENT SERIAL NO.	ASG.	TYPE	ST.	CTY.	FUND SYMBOL	ACRES/UNITS	RATE

AMOUNT	ANV. DATE	EXP. DATE	BILL CYC.	S/C	DISTRICT	NEXT BILL	MISC. DATA	U of M	ACTUAL UNITS

APPLY REMITTANCE			
ACTION	FUND SYMBOL	CTY.	AMOUNT
FILING FEE			
RENTAL			
UNEARNED			
REFUND			
TOTAL			
AMOUNT DUE			

Remarks:

*ack.
12-22-89
AM*

BY: _____ DATE: _____

- Lease in Escrow?
- KGS? Of Interest?
- Auto Escalates? Operating Rights?
- Auto Renew? Operator
- Bond Filed?

FOR MMS USE ONLY		
BILLEE		FOREST REFUGE
NUMBER		
OCS SECTION		
CODE		

203191

STATE OF ARIZONA, } I hereby certify that the within instrument was filed and recorded | Fee No.:

County of _____ } ss. _____

In Docket No. _____, Page _____

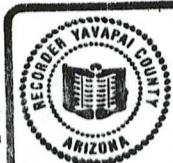

INSTRUMENT # 8829888
OFFICIAL RECORDS OF
YAVAPAI COUNTY
PATSY C. JENNEY
REQUEST OF:

ARVIN STOTT
DATE: 08/18/88 TIME: 11:45
FEE: 5.00
BOOK 2071 PAGE 263 PAGES: 001

When recorded mail to:

Box 350
~~_____~~
Bayfield CO 81122

INDEXED & LISTED
AFFIDAVIT OF PERFORMANCE OF ANNUAL WORK

State of Arizona } ss

County of YAVAPAI

\$	3	1	P	4	Co	5	St
	Bk		Map				Pcl

1. Arvin Stott Name

PO Box 839 Address

Black Canyon City City ARIZ. State 85324 Zip

being duly sworn according to law deposes and says that they are a citizen of the United States more than eighteen years of age and that all of the facts set forth in this affidavit are true and correct according to the best of their knowledge, information and belief.

2. That they are personally acquainted with the mining claim named Honey bee Amc 203191 situate in the Black Canyon Mining District, Yavapai County, Arizona, the location of which is recorded in the office of the County Recorder of that County in Book 1560, Page 142. Notice of location is posted in Section 32, Township 9 1/2, Range 2-E, G&SRB&M.

3. That between the dates of Sept. 1, 1987 and Aug. 15 - 1988 at least \$200.00 - two Hundred Dollars (\$200.00) dollars worth of work and improvements were done and performed upon this claim not including location work.

4. The work and improvements were made by and at the expense of Arvin Stott, owners of the mine for the purpose of complying with the laws of the United States pertaining to assessments or annual work.

5. Lynn Stott - Mike Jason - Arvin Stott were the names of the persons employed by the owner who labored to do the work and improvements.

6. The work and improvements done were Excavation + mining

RECEIVED
B.L.M. AZ STATE OFFICE
DEC 20 12 54 PM '88
PHOENIX, ARIZONA

Dated 8-18-88 Arvin Stott Signature

Subscribed to and sworn before me, a Notary Public, this 18 day of oct., 1988, by Arvin Stott

BOOK 2071 PAGE 263

My Commission expires _____
OFFICIAL SEAL
KAREN E. WALSER
NOTARY PUBLIC
YAVAPAI COUNTY
MY COM. EXPIRES MARCH 5, 1991

Karen E. Walsen
Notary Public

203191 SR

STATE OF ARIZONA RECEIVED I hereby certify that the within instrument was filed and recorded Fee No.:

County of B.L.H. 2274 SS OFFICE
In Docket No. DEC 4 10 48 AM '87, Page _____
PHOENIX, ARIZONA
When recorded mail to: _____

RECORDED YAVAPAI COUNTY ARIZONA

INSTRUMENT # 8731608
OFFICIAL RECORDS OF
YAVAPAI COUNTY
PATSY C. JENNEY
REQUEST OF:
ARRIN STOTT
DATE: 08/11/87 TIME: 09:30
FEE: 5.00
BOOK 1962 PAGE 306 PAGES: 001

INDEXED

Below

MICROFILMED

AFFIDAVIT OF PERFORMANCE OF ANNUAL WORK

State of Arizona
County of Yavapai } ss

\$ <u>5</u>	<u>1</u> W	<u>4</u> V	<u>5</u> St
Bk	Map	Pcl	

1. Arvin Stott
Name
Box 839
Address
Black Canyon City Arizona 85324
City State Zip

being dtly sworn according to law deposes and says that they are a citizen of the United States more than eighteen years of age and that all of the facts set forth in this affidavit are true and correct according to the best of their knowledge, information and belief.

2. That they are personally acquainted with the mining claim named Honey Bee
AMC 203191 situate in the Black Canyon Mining District,
Yavapai County, Arizona, the location of which is recorded in the office of
the County Recorder of that County in Book 1560, Page 142. Notice of
location is posted in Section 32, Township 9 1/2, Range 2-E, G&SRB&M.

3. That between the dates of Sept. 1, 1986 and Aug. 30, 1987
at least two Hundred Dollars (\$200.00)
dollars worth of work and improvements were done and performed upon this claim not including
location work.

4. The work and improvements were made by and at the expense of Arvin Stott
_____, owners of the mine for the
purpose of complying with the laws of the United States pertaining to assessments or annual work.

5. Lynn Stott + Arvin Stott

were the names of the persons employed by the owner who labored to do the work and improvements.

6. The work and improvements done were Excavation - mining + Road work

Dated 8-11-1987 _____
Signature

Subscribed to and sworn before me, a Notary Public, this 11th day of August,
1987 by Arvin Stott

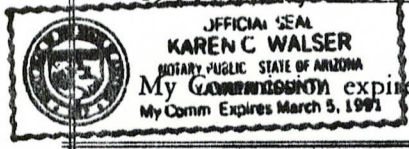

BOOK 1962 PAGE 306

Karen C. Walser
Notary Public

203191

FILED

STATE OF ARIZONA, } ss. I hereby certify that the within instrument was filed and recorded
County of _____, 19____, at _____ M.

Fee No.: 00



Instrument # 32127
Recorded Official Records of Yavapai County, Arizona AUG 27 '86 - 11 10 AM
at the request of Arvin Stott
PATSY C. JENNEY, County Recorder PATSY C. JENNEY
Deputy Karen Walker Page 1 of 1

INDEXED
MICROFILMED

By _____ Deputy Recorder

AFFIDAVIT OF PERFORMANCE OF ANNUAL WORK

State of Arizona }
County of Yavapai } ss

RECEIVED
B.L.M. AZ STATE OFFICE

DEC 04 1986

\$5	1	4	5
Rec Fee	P	Co	St

7:45 A.M.
PHOENIX, ARIZONA

1. Arvin Stott
Name
P.O. Box 839
Address
Black Canyon City Arizona 85324
City State Zip

being duly sworn according to law deposes and says that they are a citizen of the United States more than eighteen years of age and that all of the facts set forth in this affidavit are true and correct according to the best of their knowledge, information and belief.

- That they are personally acquainted with the mining claim named Honey Bee A.M.C. 203191 situate in the Black Canyon Mining District, Yavapai County, Arizona, the location of which is recorded in the office of the County Recorder of that County in Book 1560, Page 142. Notice of location is posted in Section 32, Township 9 1/2, Range 2-E, G&SRB&M.
- That between the dates of Sept. 1 1985 and Aug. 30 1986 at least two Hundred Dollars (~~\$200.00~~) dollars worth of work and improvements were done and performed upon this claim not including location work.
- The work and improvements were made by and at the expense of Arvin Stott, owners of the mine for the purpose of complying with the laws of the United States pertaining to assessments or annual work.
- Lynn Stott - Joe Straayer + Arvin Stott were the names of the persons employed by the owner who labored to do the work and improvements.
- The work and improvements done were Excavation - mining + Removal of over burden.

Dated 8-27-86

Arvin Stott
Signature

SEAL

Subscribed to and sworn before me, a Notary Public, this 27th day of August, 1986, by Arvin Stott

BOOK 1851 PAGE 403

My Commission expires June 28 1987

[Signature]
Notary Public

203191 *SR*

RUSH

STATE OF ARIZONA, } ss. I hereby certify that the within instrument was filed and recorded
County of _____, 19____, at _____M.

Fee No.:
**INDEXED
MICROFILMED**

In Docket No. _____, Page _____

Instrument # **27885**
Recorded Official Records
of Yavapai County, Arizona.
AUG 20 '85 - 1 00 PM
Arvin Stott
at the request of
PATSY C. JENNEY, County Recorder Pgs. 1
Deputy *Karen Walsen*

When recorded mail to:

Below

Fee: \$ *5/ea*
p

AFFIDAVIT OF PERFORMANCE OF ANNUAL WORK

State of Arizona }
County of *Yavapai* } ss. *Amc*
203191

RECEIVED
P. I. M. AZ STATE OFFICE
NOV 04 1985
7:45 A.M.
PHOENIX, ARIZONA

1. *Arvin Stott*
Name
P.O. Box 839
Address
Black Canyon City City *AZ-* State *85324* Zip

being duly sworn according to law deposes and says that they are a citizen of the United States more than eighteen years of age and that all of the facts set forth in this affidavit are true and correct according to the best of their knowledge, information and belief.

2. That they are personally acquainted with the mining claim named *Honey Bee* situate in the *Black Canyon* Mining District, *Yavapai* County, Arizona, the location of which is recorded in the office of the County Recorder of that County in Book *1560*, Page *141*. Notice of location is posted in Section *32*, Township *9 1/2 N*, Range *2-E*, G&SRB&M.

3. That between the dates of *Sept. 1, 1984* and *Aug. 20, 1985* at least *two Hundred* (*\$200.00*) dollars worth of work and improvements were done and performed upon this claim not including location work.

4. The work and improvements were made by and at the expense of *Arvin Stott*, owners of the mine for the purpose of complying with the laws of the United States pertaining to assessments or annual work.

5. *Arvin Stott - Lynn Stott - Rex Sharp* were the names of the persons employed by the owner who labored to do the work and improvements.

6. The work and improvements done were *Excavation - Removal of overburden*

600: **1747** PAGE **316**

Dated *8-20-1985* *Arvin Stott* Signature

Subscribed to and sworn before me, a Notary Public, this *20th* day of *Aug*, 19 *85*, by *Arvin Stott*

My Comm. Expires _____
Dorothy J. Clippes
Notary Public

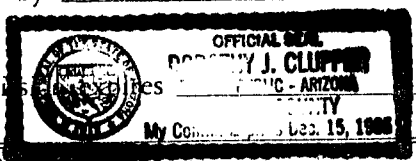

NOTICE!!

These documents have been scanned!

Do not place un-scanned documents beneath this notice!

Do not remove this notice from this file!

GPO Jacket No. 560-102
Print Order 61540
Rise Business Services, LLC
Job=AZ15 8/2/2019



Box Number= AZ15210



Claim Begin-End: AMC203191-AMC203191

5 Miscellaneous



AZ15210-4

AMC196365-AMC210385

**NO
DOCUMENTS
FOUND**

NO DOCUMENTS FOUND
NO DOCUMENTS FOUND

NOTICE!!

These documents have been scanned!

Do not place un-scanned documents beneath this notice!

Do not remove this notice from this file!

GPO Jacket No. 560-102
Print Order 61540
Rise Business Services, LLC
Job=AZ15 8/2/2019



Box Number= AZ15210



Claim Begin-End: AMC203191-AMC203191

6 Location Notices-Amendments and Supporting Documents



AZ15210-4

AMC196365-AMC210385

STATE OF ARIZONA, } I hereby certify that the within instrument was filed and recorded
 County of _____ } ss. _____ 19 _____ at _____ M.
 In Docket No. _____, Page _____

Fee No.:

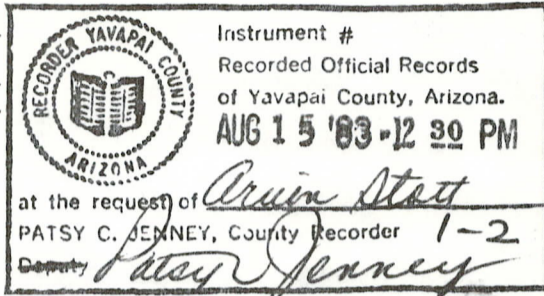

When recorded mail to:

Fee: \$ 5.00^P

A MC 203191

NOTICE OF MINING CLAIM LOCATION

1. Location Amendment Relocation
 2. Placer Lode Millsite
 3. The name and address of the Locator is

RECEIVED
 B.M. AZ STATE OFFICE
 AUG 16 10 30 AM '83
 PHOENIX, ARIZONA

ARVIN Stott Name

TO P.O. Box 839 Address

Black Canyon City City ARIZ. State 85324 Zip

4. The name of the claim is Honeybee
 5. The date of the location is Aug 15 1983
 6. The claim is 936 feet long and 930 feet wide. The distance from the Location monument to each end of the claim is 936 feet in a Westerly direction and 0 feet in a Easterly direction.
 7. The general course of the claim is from the East to the West
 8. The location of the claim is in Section 32, Township 9 1/2 N, Range 2E G&SRB&M Black Canyon Mining District, Yavapai County, Arizona.
 9. If amending or relocating, the previous claim name was _____ recorded in Docket _____, Book _____, Mining District, _____ County, Arizona.
 10. The location of the claim with reference to a natural object or permanent monument is Beginning at a point 1320' W. from the corner of Sections 33-32-5-4 T. 9 1/2 N. R. 2E Go W. 936' Then N. 930' Then E. 936' Then South 930' To point of Beginning.

1560 141

Date Aug 15 1983

[Signature]
 Signature

MAP OF MINING CLAIM LOCATION

1. The name of the claim is Honey bee
2. The S.E. corner of the claim is 1320 feet in a Westerly direction
 From to a survey monument or permanent natural object described as The SE-SW-NW-NE
 Corner of Sec 33-32-5-4 T9 1/2 N. R2E
3. The type of location monument is 4" x 4" x 4' Post
 The type of corner and end monuments are 4" x 4" x 4' Post
4. The bearing and distance between the corners of the claim are beginning at the SE
 corner of the claim, 936 feet in a Westerly direction to the S.W.
 corner, then 930 feet in a Northerly direction to the N.W. corner,
 then 936 feet in a Easterly direction to the N.E. corner, then
 930 feet in a Southerly direction to the point of beginning.

MAP

One inch = One thousand feet

North Arrow



ONE MILE

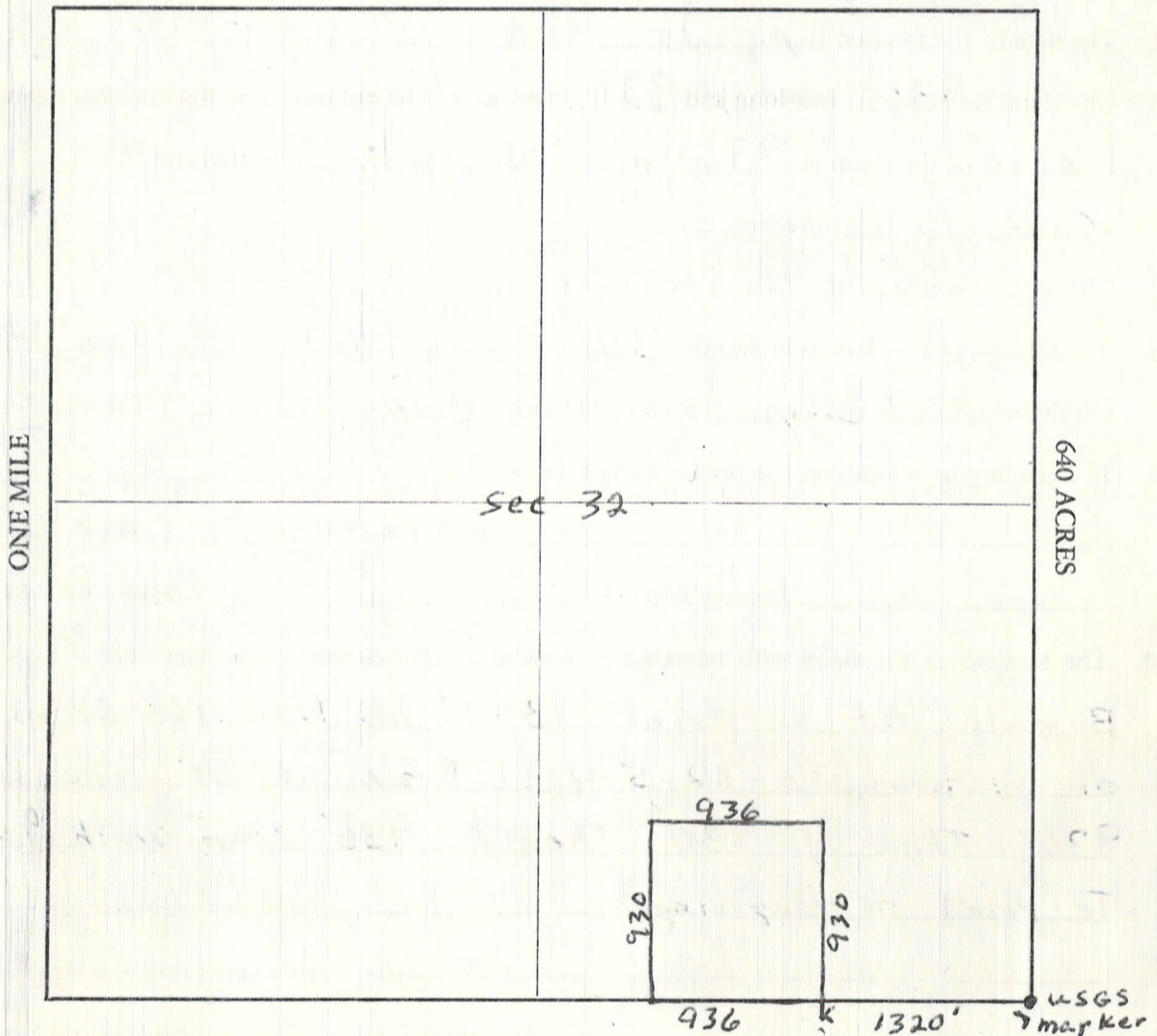

Section 32 Range 2E Township 9 1/2 N G&SRB&M

Date Aug 15 - 1983

BOOK 1560 PAGE 142

[Signature]
Signature